

Gate Burton Energy Park Environmental Statement

Volume 3, Appendix 10-I: Arboricultural Impact Assessment Part 2
Document Reference: EN010131/APP/3.3
January 2023

APFP Regulation 5(2)(a)
Planning Act 2008
Infrastructure Planning (Applications: Prescribed Forms and Procedure) Regulations 2009

Annex D. Tree Protection and Removal Plan

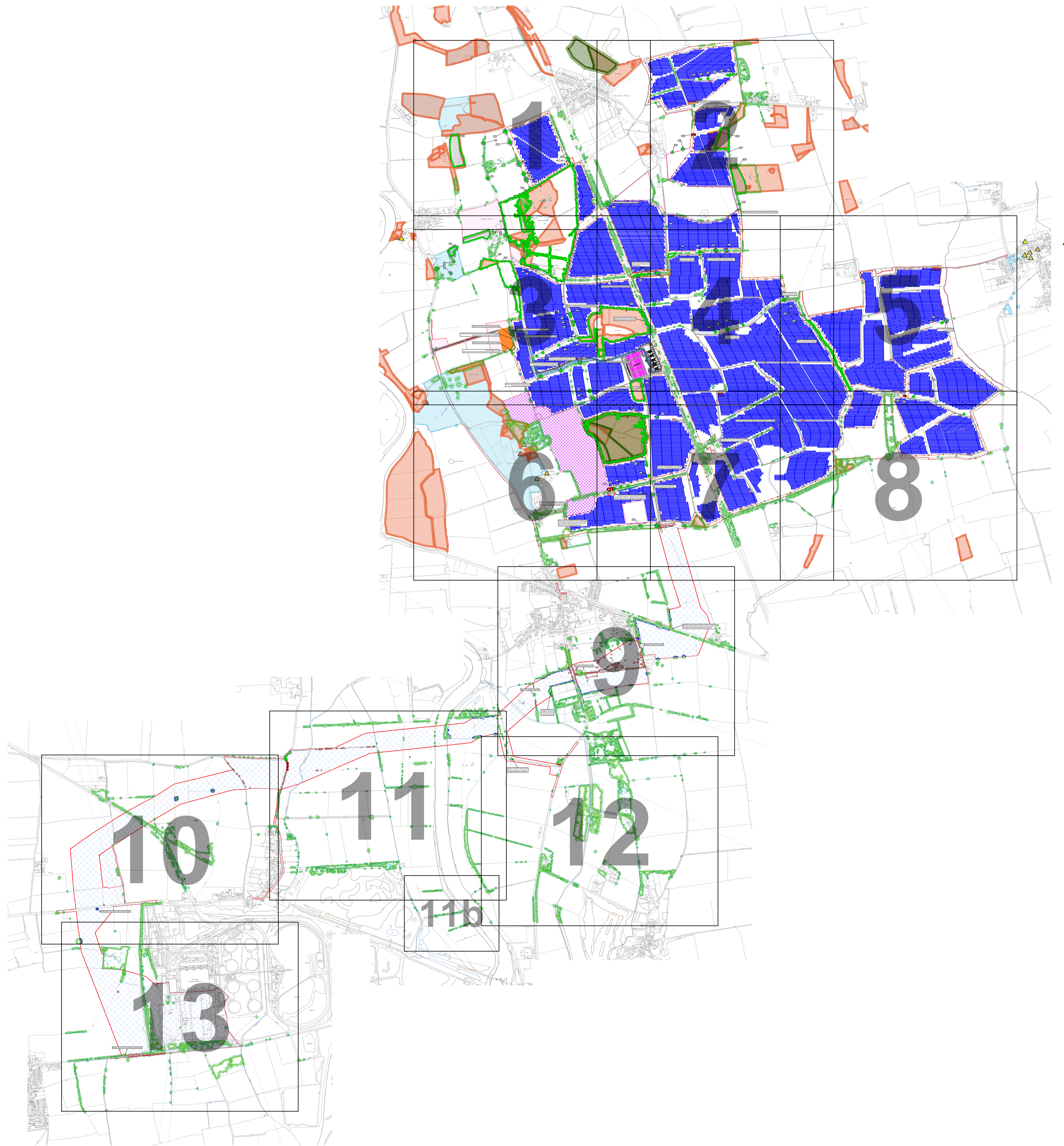

PROJECT
GATE BURTON ENERGY PARK
CLIENT

GATE BURTON ENERGY PARK LTD
CONSULTANT

AECOM
 Plumer House, Third Floor,
 East Wing, Tallyour Road
 Plymouth, PL6 5DH
 Tel +44(0)1752 676700
 Fax +44(0)870 238 6023
 www.aecom.com

GENERAL NOTES

1. TREE CATEGORIES AS DEFINED BY BS 5837:2012
2. TREE LOCATIONS ARE BASED ON A COMBINATION OF OS MAPPING, AERIAL IMAGERY, NATIONAL TREE MAP AND GPS CO-ORDINATES FROM ON SITE WALKOVER
3. PLANS SHOULD BE READ IN CONJUNCTION WITH THE AECOM ARBORICULTURAL REPORT
4. THE ORIGINAL OF THIS DRAWING WAS PRODUCED IN COLOUR - A MONOCHROME COPY SHOULD NOT BE RELIED UPON
5. DRAWING REFERENCES:
 Ancient Woodlands.dwg
 Priority Habitats.dwg
 OS_TR.dwg
 NTM COMBINED DATA_TR.dwg
 NTM Polygons - Copy.dwg
 TPO XREF.dwg
 LCA:2021-GateBurton_DS_00003_IllustrativeSiteLayout-DCOApplicationReference-A (Mod)

KEY PLAN

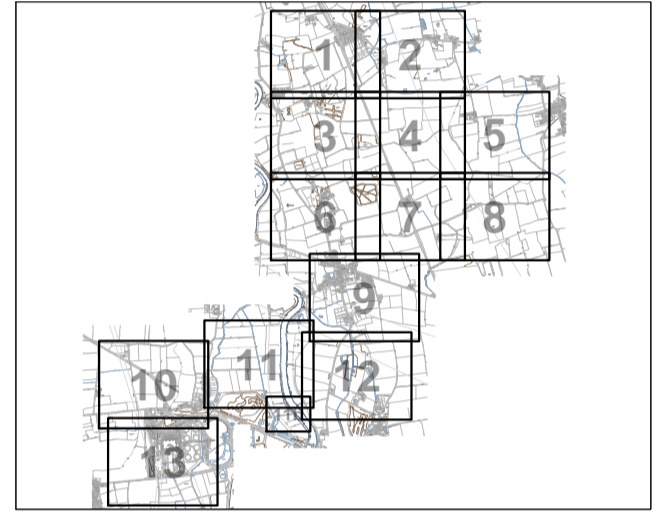

KEY

- SITE BOUNDARY
- EXISTING TREE, GROUP, WOODLAND, OR HEDGE TO BE RETAINED
- EXISTING NTM FEATURE TO BE RETAINED
- EXISTING TREE, GROUP, WOODLAND, OR HEDGE TO BE REMOVED
- EXISTING NTM FEATURE TO BE REMOVED
- ROOT PROTECTION AREA OF RETAINED TREES (AS DEFINED BY BS 5837:2012)
- ROOT PROTECTION AREA OF NTM FEATURE (AS DEFINED BY BS 5837:2012)
- VETERAN TREE ROOT PROTECTION AREAS (RPA) (AS DEFINED BY BS 5837:2012)
- TREE PROTECTION FENCING
- CONSTRUCTION EXCLUSION ZONE (EXERCISES OF HEAVY MACHINERY STORAGE, EXCAVATION AND ALL OTHER CONSTRUCTION ACTIVITIES ARE EXCLUDED WITHIN THESE AREAS FOR THE PURPOSES OF PROTECTING TREE HEALTH)
- CONSTRUCTION WORKING ZONE (MANAGED CONSTRUCTION PROCESSES PERMITTED IN ACCORDANCE WITH THE PRINCIPLES SET OUT WITHIN THE ARBORICULTURAL IMPACT ASSESSMENT)
- ANCIENT WOODLAND (WITH 15M BUFFER) (AREA CLASSIFIED AS AN ANCIENT WOODLAND)
- PRIORITY HABITAT (CLASSIFIED AS A PRIORITY HABITAT)

ISSUE/REVISION

NO	DATE	DESCRIPTION
P01	23.01.23	FIRST ISSUE
VR		

DRAWING STATUS

ISSUE

PROJECT NUMBER

60664324

SHEET TITLE

TREE PROTECTION AND REMOVALS PLAN (SHEET 00)

SHEET NUMBER

60664324-ACM-XX-XX-AB-TPP-000

REV.

P01

This drawing has been prepared for the use of AECOM's client. It may not be used, modified, reproduced or relied upon by third parties, except as agreed by AECOM or as required by law. AECOM accepts no responsibility and denies any liability whatsoever to any party that uses or relies on this drawing without AECOM's express written consent. Do not scale this document. All measurements must be obtained from the stated dimensions.

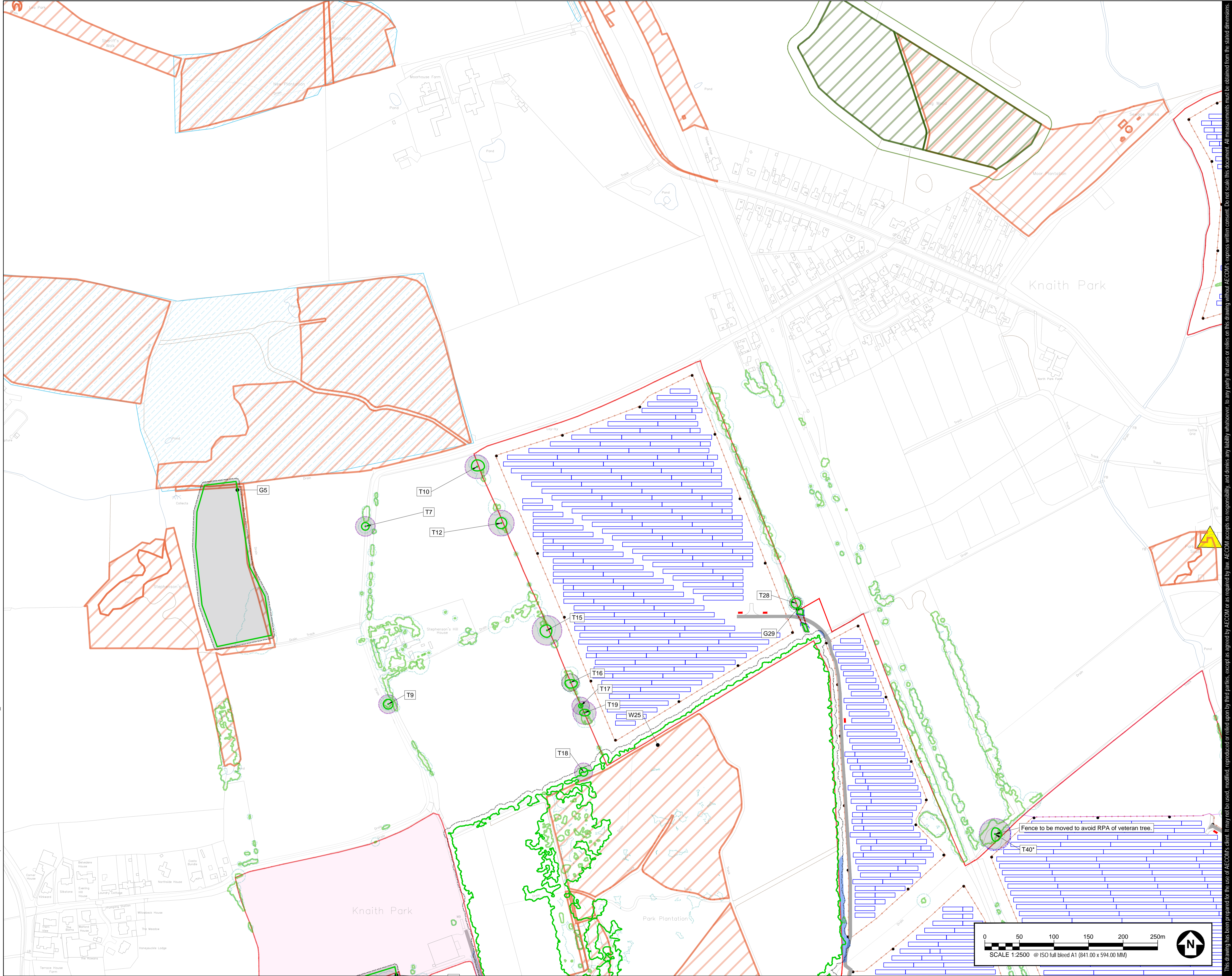

GENERAL NOTES

1. TREE CATEGORIES AS DEFINED BY BS 5837:2012
2. TREE LOCATIONS ARE BASED ON A COMBINATION OF OS MAPPING, AERIAL IMAGERY, NATIONAL TREE MAP AND GPS CO-ORDINATES FROM ON SITE WALKOVER
3. PLANS SHOULD BE READ IN CONJUNCTION WITH THE AECOM ARBORICULTURAL REPORT
4. THE ORIGINAL OF THIS DRAWING WAS PRODUCED IN COLOUR. A MONOCHROME COPY SHOULD NOT BE RELIED UPON.
5. DRAWING REFERENCES:
Ancient Woodlands.dwg
Priority Habitats.dwg
OS_TR.dwg
NTM COMBINED DATA_TR.dwg
NTM Polygons - Copy.dwg
TPO XREF.dwg
LCA_2021-GateBurton_DS_00003_IllustrativeSiteLayout-DCOApplicationReference-A (Mod)

KEY PLAN

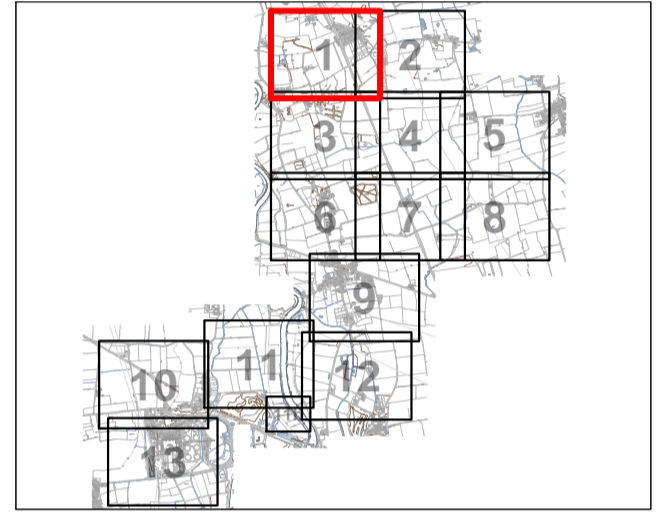

KEY

- SITE BOUNDARY
- EXISTING TREE, GROUP, WOODLAND, OR HEDGE TO BE RETAINED
- EXISTING NTM FEATURE TO BE RETAINED
- EXISTING TREE, GROUP, WOODLAND, OR HEDGE TO BE REMOVED
- EXISTING NTM FEATURE TO BE REMOVED (AS DEFINED BY BS 5837:2012)
- ROOT PROTECTION AREA OF RETAINED TREES (AS DEFINED BY BS 5837:2012)
- ROOT PROTECTION AREA OF NTM FEATURE (AS DEFINED BY BS 5837:2012)
- VETERAN TREE ROOT PROTECTION AREAS (RPA) (AS DEFINED BY BS 5837:2012)
- TREE PROTECTION FENCING
- CONSTRUCTION EXCLUSION ZONE (EXCLUSION OF PLANT MATERIALS STORAGE, EXCAVATION AND ALL OTHER CONSTRUCTION ACTIVITIES. ARE EXCLUDED WITHIN THESE AREAS FOR THE PURPOSES OF PROTECTING TREE HABITAT)
- CONSTRUCTION WORKING ZONE (DAMAGED CONSTRUCTION PROCESSES PERMITTED IN ACCORDANCE WITH THE PRINCIPLES SET OUT WITHIN THE ARBORICULTURAL IMPACT ASSESSMENT)
- ANCIENT WOODLAND (WITH 15M BUFFER) (AREA CLASSIFIED AS AN ANCIENT WOODLAND)
- PRIORITY HABITAT (CLASSIFIED AS A PRIORITY HABITAT)

ISSUE/REVISION

NO	DATE	DESCRIPTION
P01	23.01.23	FIRST ISSUE
VR		

DRAWING STATUS
ISSUE

PROJECT NUMBER
60664324

SHEET TITLE
TREE PROTECTION AND REMOVALS PLAN (SHEET 1)

SHEET NUMBER **REV.**
60664324-ACM-XX-XX-AB-TPP-01 P01

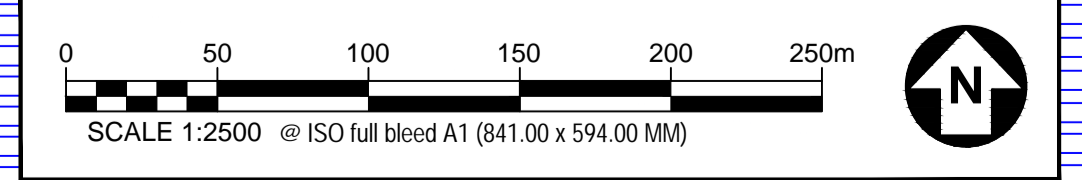

This drawing has been prepared for the use of AECOM's Client. It may not be used, modified, reproduced or relied upon by third parties, except as agreed by AECOM or as required by law. AECOM accepts no responsibility, and denies any liability whatsoever, to any party that uses or relies on this drawing without AECOM's express written consent. Do not scale this document. All measurements must be obtained from the scaled dimensions.

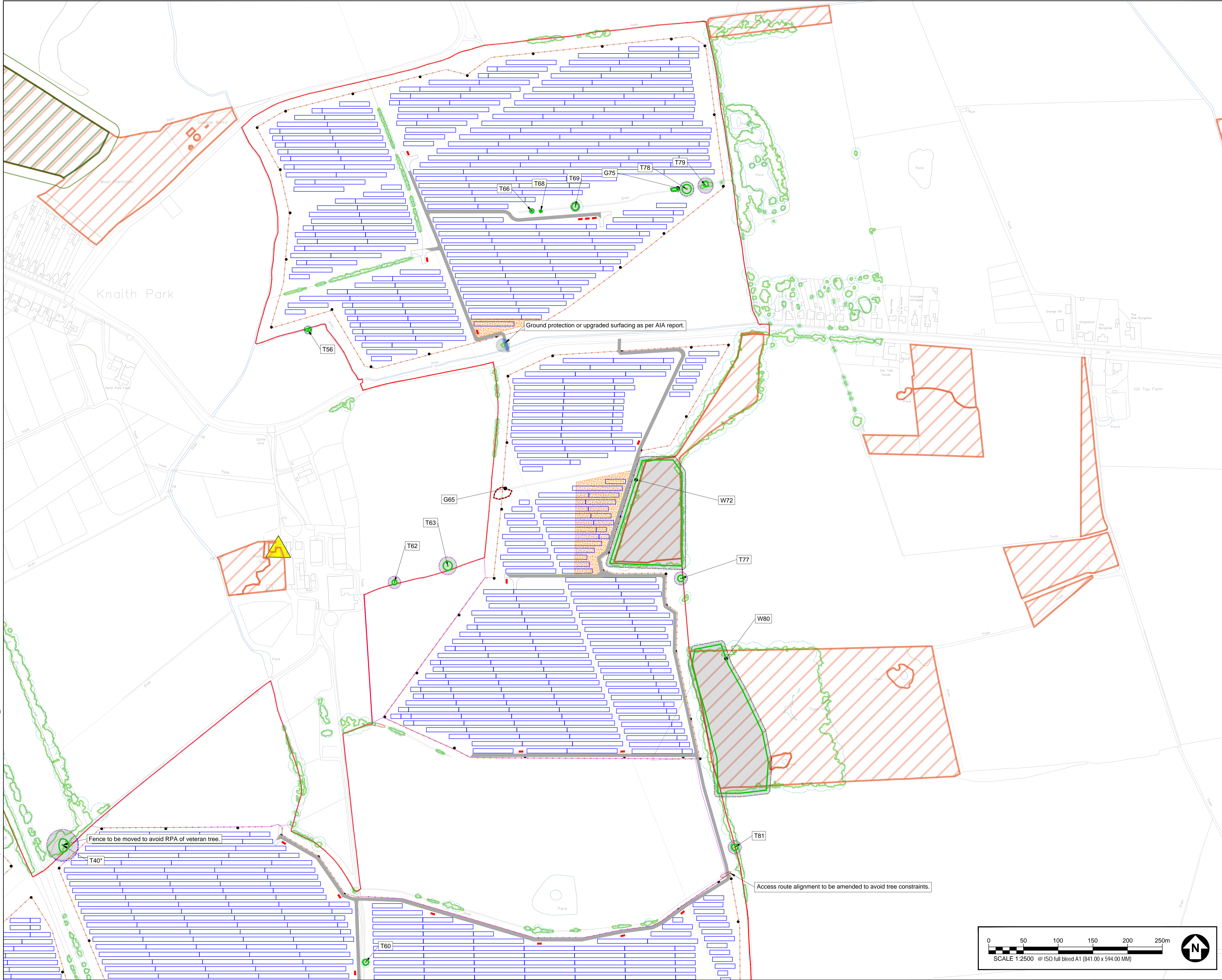

GENERAL NOTES

1. TREE CATEGORIES AS DEFINED BY BS 5837:2012
2. TREE LOCATIONS ARE BASED ON A COMBINATION OF OS MAPPING, AERIAL IMAGERY, NATIONAL TREE MAP AND GPS CO-ORDINATES FROM ON SITE WALKOVER
3. PLANS SHOULD BE READ IN CONJUNCTION WITH THE AECOM ARBORICULTURAL REPORT
4. THE ORIGINAL OF THIS DRAWING WAS PRODUCED IN COLOUR. A MONOCHROME COPY SHOULD NOT BE RELIED UPON.
5. DRAWING REFERENCES:
 Ancient Woodlands.dwg
 Priority Habitats.dwg
 OS_TR.dwg
 NTM COMBINED DATA_TR.dwg
 NTM Polygons - Copy.dwg
 TPO XREF.dwg
 LCA:2021-GateBurton_DS_00003_IllustrativeSiteLayout-DCOApplicationReference-A (Mod)

KEY PLAN

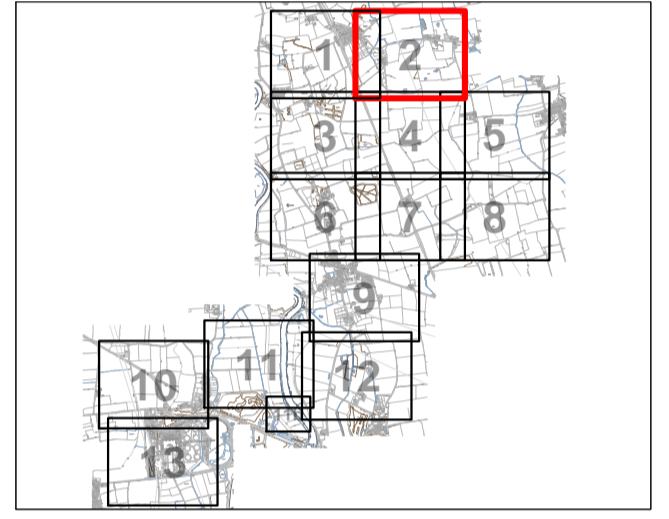

KEY

- SITE BOUNDARY
- EXISTING TREE, GROUP, WOODLAND, OR HEDGE TO BE RETAINED
- EXISTING NTM FEATURE TO BE RETAINED
- EXISTING TREE, GROUP, WOODLAND, OR HEDGE TO BE REMOVED
- EXISTING NTM FEATURE TO BE REMOVED
- ROOT PROTECTION AREA OF RETAINED TREES (AS DEFINED BY BS 5837:2012)
- ROOT PROTECTION AREA OF NTM FEATURE (AS DEFINED BY BS 5837:2012)
- VETERAN TREE ROOT PROTECTION AREAS (RPA) (AS DEFINED BY BS 5837:2012)
- TREE PROTECTION FENCING
- CONSTRUCTION EXCLUSION ZONE (CONSTRUCTION OF BLANK MATERIALS STORAGE, EXCAVATION AND ALL OTHER CONSTRUCTION ACTIVITIES ARE EXCLUDED WITHIN THESE AREAS FOR THE PURPOSES OF PROTECTING TREE HEALTH)
- CONSTRUCTION WORKING ZONE (MANAGED CONSTRUCTION PROCESSES PERMITTED IN ACCORDANCE WITH THE PRINCIPLES SET OUT WITHIN THE ARBORICULTURAL IMPACT ASSESSMENT)
- ANCIENT WOODLAND (WITH 15M BUFFER) (AREA CLASSIFIED AS AN ANCIENT WOODLAND)
- PRIORITY HABITAT (CLASSIFIED AS A PRIORITY HABITAT)

ISSUE/REVISION

NO	DATE	DESCRIPTION
P01	23.01.23	FIRST ISSUE
I/R	DATE	DESCRIPTION

DRAWING STATUS
ISSUE

PROJECT NUMBER
 60664324

SHEET TITLE
TREE PROTECTION AND REMOVALS PLAN (SHEET 2)

SHEET NUMBER **REV.**
 60664324-ACM-XX-XX-AB-TPP-02 P01

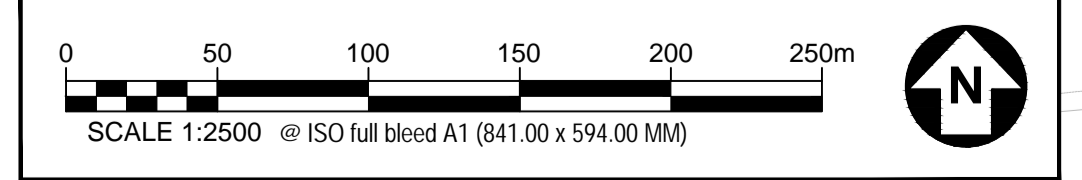

This drawing has been prepared for the use of AECOM's Client. It may not be used, modified, reproduced or relied upon by third parties, except as agreed by AECOM or as required by law. AECOM accepts no responsibility and denies any liability whatsoever, to any party that uses or relies on this drawing without AECOM's express written consent. Do not scale this document. All measurements must be obtained from the stated dimensions.

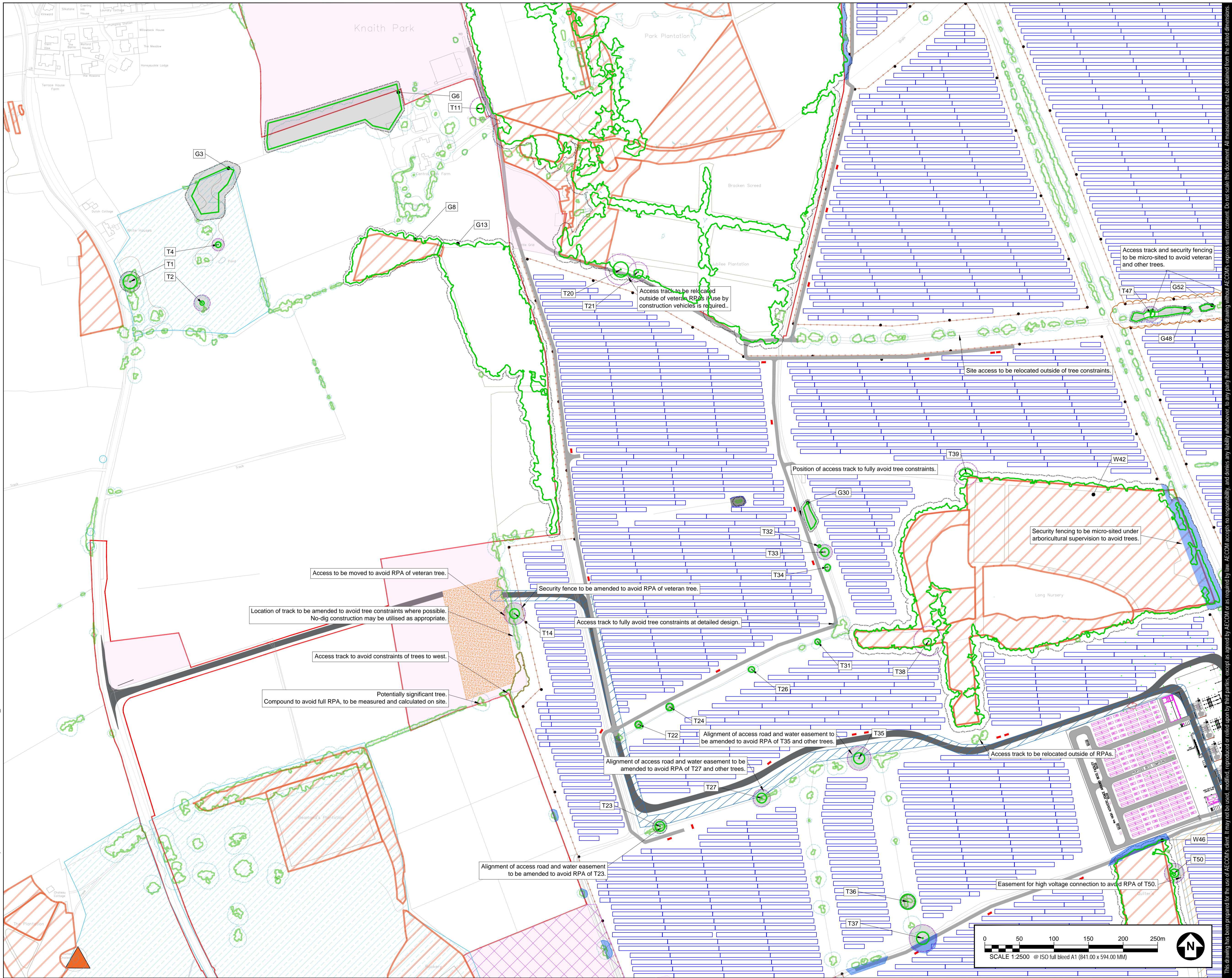

- GENERAL NOTES**
1. TREE CATEGORIES AS DEFINED BY BS 5837:2012
 2. TREE LOCATIONS ARE BASED ON A COMBINATION OF OS MAPPING, AERIAL IMAGERY, NATIONAL TREE MAP AND GPS CO-ORDINATES FROM ON SITE WALKOVER
 3. PLANS SHOULD BE READ IN CONJUNCTION WITH THE AECOM ARBORICULTURAL REPORT
 4. THE ORIGINAL OF THIS DRAWING WAS PRODUCED IN COLOUR. A MONOCHROME COPY SHOULD NOT BE RELIED UPON.
 5. DRAWING REFERENCES:
 Ancient Woodlands.dwg
 Priority Habitats.dwg
 OS_TR.dwg
 NTM COMBINED DATA_TR.dwg
 NTM Polygons - Copy.dwg
 TPO XREF.dwg
 LCA:2021-GateBurton_DS_00003_IllustrativeSiteLayout-DCOApplicationReference-A (Mod)

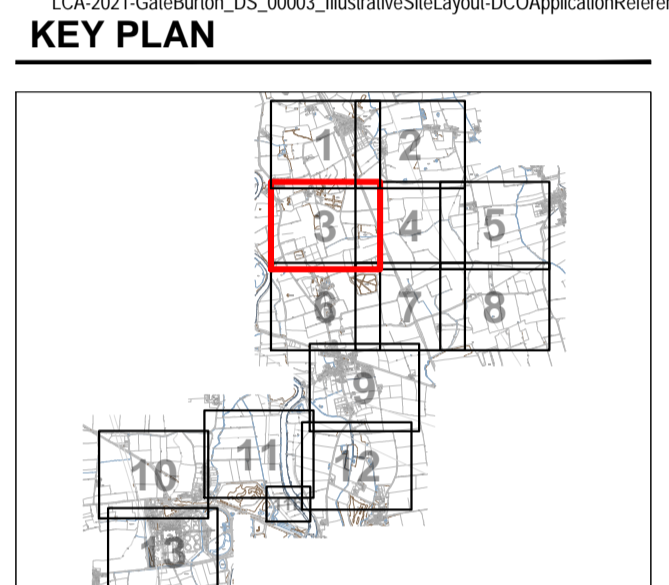

- KEY**
- SITE BOUNDARY
 - EXISTING TREE, GROUP, WOODLAND, OR HEDGE TO BE RETAINED
 - EXISTING NTM FEATURE TO BE RETAINED
 - EXISTING TREE, GROUP, WOODLAND, OR HEDGE TO BE REMOVED
 - EXISTING NTM FEATURE TO BE REMOVED
 - ROOT PROTECTION AREA OF RETAINED TREES (AS DEFINED BY BS 5837:2012)
 - ROOT PROTECTION AREA OF NTM FEATURE (AS DEFINED BY BS 5837:2012)
 - VETERAN TREE ROOT PROTECTION AREAS (RPA) (AS DEFINED BY BS 5837:2012)
 - TREE PROTECTION FENCING
 - CONSTRUCTION EXCLUSION ZONE (EXERCISES OF PLANT MATERIALS STORAGE, EXCAVATION AND ALL OTHER CONSTRUCTION ACTIVITIES ARE EXCLUDED WITHIN THESE AREAS FOR THE PURPOSES OF PROTECTING TREE HEALTH)
 - CONSTRUCTION WORKING ZONE (MANAGED CONSTRUCTION PROCESSES PERMITTED IN ACCORDANCE WITH THE PRINCIPLES SET OUT WITHIN THE ARBORICULTURAL IMPACT ASSESSMENT)
 - ANCIENT WOODLAND (WITH 15M BUFFER) (AREA CLASSIFIED AS AN ANCIENT WOODLAND)
 - PRIORITY HABITAT (CLASSIFIED AS A PRIORITY HABITAT)

ISSUE/REVISION

NO	DATE	DESCRIPTION
P01	23.01.23	FIRST ISSUE
VR		

DRAWING STATUS
ISSUE

PROJECT NUMBER
 60664324

SHEET TITLE
TREE PROTECTION AND REMOVALS PLAN (SHEET 3)

SHEET NUMBER **REV.**
 60664324-ACM-XX-XX-AB-TPP-03 P01

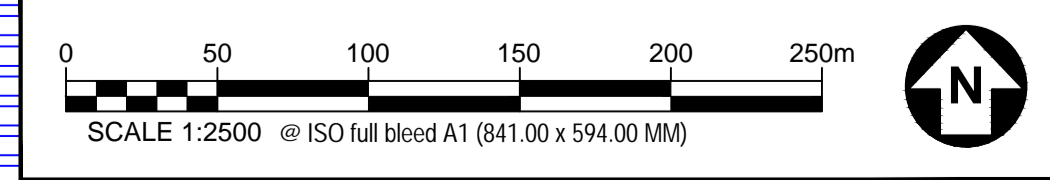

This drawing has been prepared for the use of AECOM's client. It may not be used, modified, reproduced or relied upon by third parties, except as agreed by AECOM or as required by law. AECOM accepts no responsibility and denies any liability whatsoever to any party that uses or relies on this drawing without AECOM's express written consent. Do not scale this document. All measurements must be obtained from the stated dimensions.

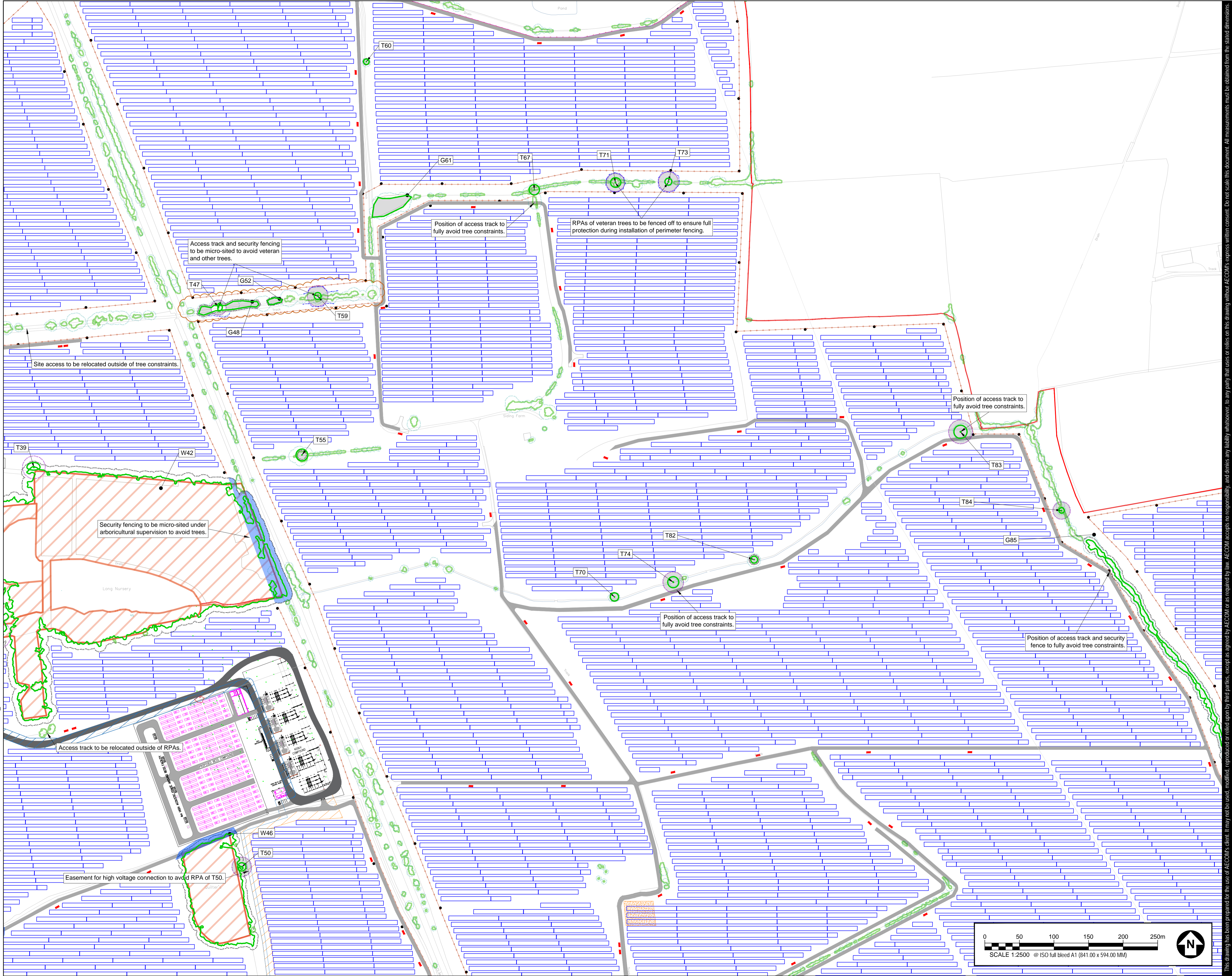

GENERAL NOTES

1. TREE CATEGORIES AS DEFINED BY BS 5837:2012
2. TREE LOCATIONS ARE BASED ON A COMBINATION OF OS MAPPING, AERIAL IMAGERY, NATIONAL TREE MAP AND GPS CO-ORDINATES FROM ON SITE WALKOVER.
3. PLANS SHOULD BE READ IN CONJUNCTION WITH THE AECOM ARBORICULTURAL REPORT.
4. THE ORIGINAL OF THIS DRAWING WAS PRODUCED IN COLOUR. A MONOCHROME COPY SHOULD NOT BE RELIED UPON.
5. DRAWING REFERENCES:
 Ancient Woodlands.dwg
 Priority Habitats.dwg
 OS_TR.dwg
 NTM COMBINED DATA_TR.dwg
 NTM Polygons - Copy.dwg
 TPO XREF.dwg
 LCA-2021-GateBurton_DS_00003_IllustrativeSiteLayout-DCOApplicationReference-A (Mod)

KEY PLAN

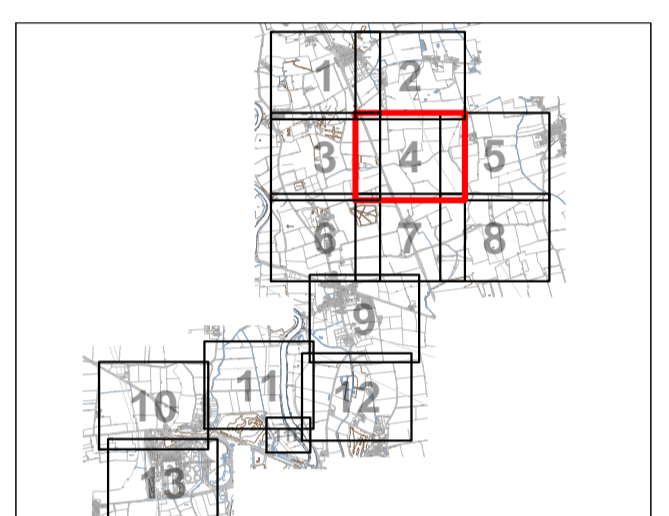

KEY

- SITE BOUNDARY
- EXISTING TREE, GROUP, WOODLAND, OR HEDGE TO BE RETAINED
- EXISTING NTM FEATURE TO BE RETAINED
- EXISTING TREE, GROUP, WOODLAND, OR HEDGE TO BE REMOVED
- EXISTING NTM FEATURE TO BE REMOVED
- ROOT PROTECTION AREA OF RETAINED TREES (AS DEFINED BY BS 5837:2012)
- ROOT PROTECTION AREA OF NTM FEATURE (AS DEFINED BY BS 5837:2012)
- VETERAN TREE ROOT PROTECTION AREAS (RPA) (AS DEFINED BY BS 5837:2012)
- TREE PROTECTION FENCING
- CONSTRUCTION EXCLUSION ZONE (CONSTRUCTION OF PLANT MATERIALS STORAGE, EXCAVATION AND ALL OTHER CONSTRUCTION ACTIVITIES ARE EXCLUDED WITHIN THESE AREAS FOR THE PURPOSES OF PROTECTING TREE HEALTH)
- CONSTRUCTION WORKING ZONE (MANAGED CONSTRUCTION PROCESSES PERMITTED IN ACCORDANCE WITH THE PRINCIPLES SET OUT WITHIN THE ARBORICULTURAL IMPACT ASSESSMENT)
- ANCIENT WOODLAND (WITH 15M BUFFER) (AREA CLASSIFIED AS AN ANCIENT WOODLAND)
- PRIORITY HABITAT (CLASSIFIED AS A PRIORITY HABITAT)

ISSUE/REVISION

NO	DATE	DESCRIPTION
P01	23.01.23	FIRST ISSUE
I/R	DATE	DESCRIPTION

DRAWING STATUS

ISSUE

PROJECT NUMBER

60664324

SHEET TITLE

TREE PROTECTION AND REMOVALS PLAN (SHEET 4)

SHEET NUMBER **REV.**

60664324-ACM-XX-XX-AB-TPP-04 P01

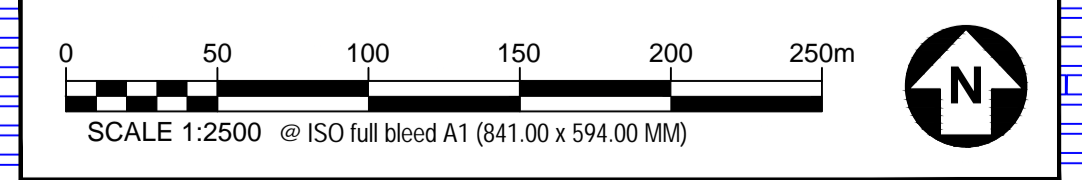

This drawing has been prepared for the use of AECOM's Client. It may not be used, modified, reproduced or relied upon by third parties, except as agreed by AECOM or as required by law. AECOM accepts no responsibility and denies any liability whatsoever to any party that uses or relies on this drawing without AECOM's express written consent. Do not scale this document. All measurements must be obtained from the stated dimensions.

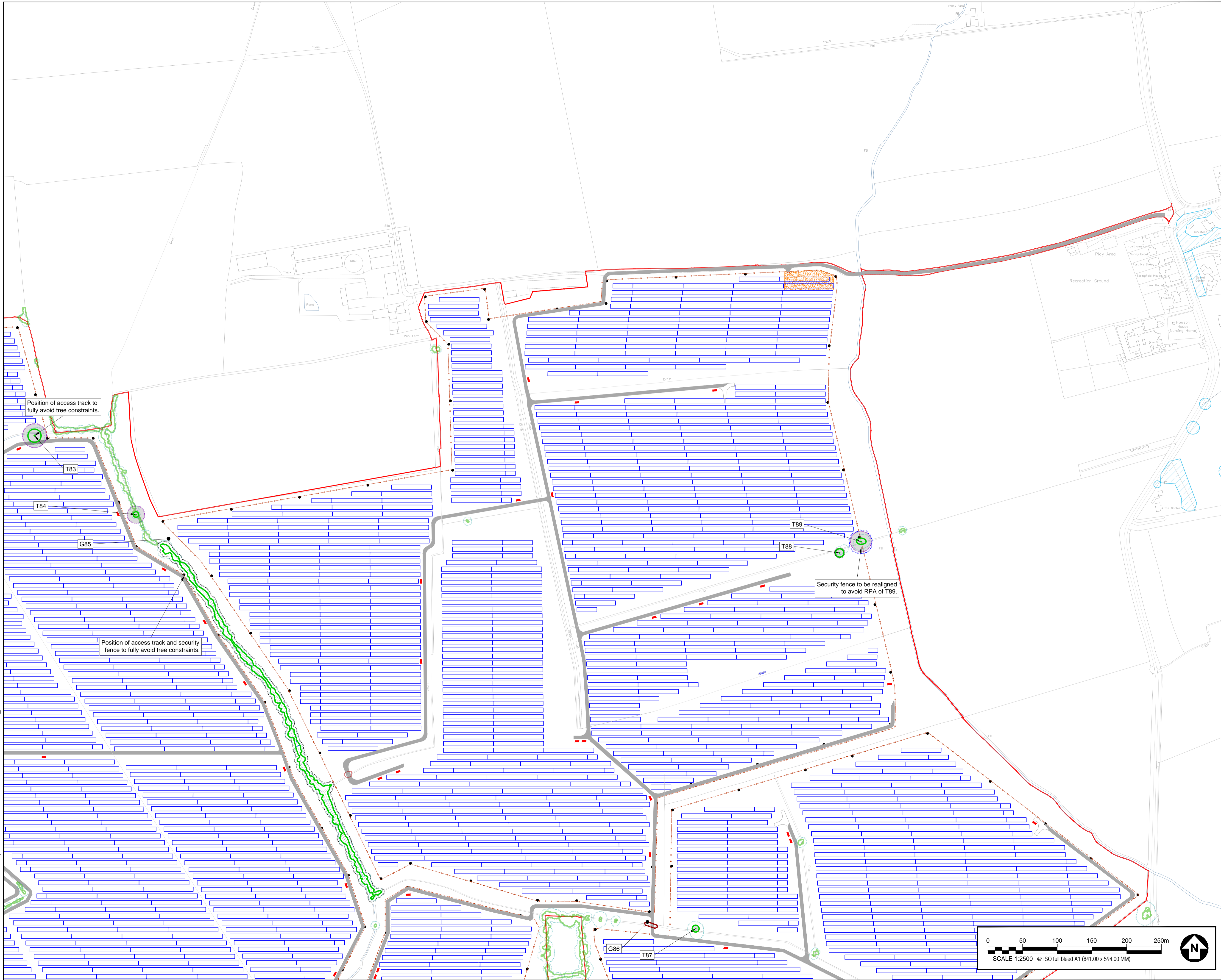

GENERAL NOTES

1. TREE CATEGORIES AS DEFINED BY BS 5837:2012
2. TREE LOCATIONS ARE BASED ON A COMBINATION OF OS MAPPING, AERIAL IMAGERY, NATIONAL TREE MAP AND GPS CO-ORDINATES FROM ON SITE WALKOVER
3. PLANS SHOULD BE READ IN CONJUNCTION WITH THE AECOM ARBORICULTURAL REPORT
4. THE ORIGINAL OF THIS DRAWING WAS PRODUCED IN COLOUR - A MONOCHROME COPY SHOULD NOT BE RELIED UPON
5. DRAWING REFERENCES:
 Ancient Woodlands.dwg
 Priority Habitats.dwg
 OS_TR.dwg
 NTM COMBINED DATA_TR.dwg
 NTM Polygons - Copy.dwg
 TPO XREF.dwg
 LCA.2021-GateBurton_DS_00003_IllustrativeSiteLayout-DCOApplicationReference-A (Model)

KEY PLAN

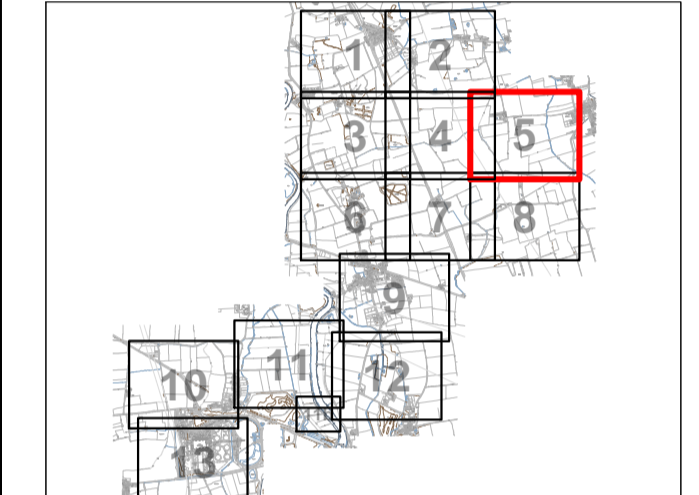

KEY

- SITE BOUNDARY
- EXISTING TREE, GROUP, WOODLAND, OR HEDGE TO BE RETAINED
- EXISTING NTM FEATURE TO BE RETAINED
- EXISTING TREE, GROUP, WOODLAND, OR HEDGE TO BE REMOVED
- EXISTING NTM FEATURE TO BE REMOVED
- ROOT PROTECTION AREA OF RETAINED TREES (AS DEFINED BY BS 5837:2012)
- ROOT PROTECTION AREA OF NTM FEATURE (AS DEFINED BY BS 5837:2012)
- VETERAN TREE ROOT PROTECTION AREAS (RPA) (AS DEFINED BY BS 5837:2012)
- TREE PROTECTION FENCING
- CONSTRUCTION EXCLUSION ZONE (CONSTRUCTION OF PLANT MATERIALS STORAGE, EXCAVATION AND ALL OTHER CONSTRUCTION ACTIVITIES ARE EXCLUDED WITHIN THESE AREAS FOR THE PURPOSES OF PROTECTING TREE HEALTH)
- CONSTRUCTION WORKING ZONE (MANAGED CONSTRUCTION PROCESSES PERMITTED IN ACCORDANCE WITH THE PRINCIPLES SET OUT WITHIN THE ARBORICULTURAL IMPACT ASSESSMENT)
- ANCIENT WOODLAND (WITH 15M BUFFER) (AREA CLASSIFIED AS AN ANCIENT WOODLAND)
- PRIORITY HABITAT (CLASSIFIED AS A PRIORITY HABITAT)

ISSUE/REVISION

NO	DATE	DESCRIPTION
P01	23.01.23	FIRST ISSUE
NR		

DRAWING STATUS

ISSUE

PROJECT NUMBER

60664324

SHEET TITLE

TREE PROTECTION AND REMOVALS PLAN (SHEET 5)

SHEET NUMBER **REV.**

60664324-ACM-XX-XX-AB-TPP-05 P01

This drawing has been prepared for the use of AECOM's client. It may not be used, modified, reproduced or relied upon by third parties, except as agreed by AECOM or as required by law. AECOM accepts no responsibility and denies any liability whatsoever to any party that uses or relies on this drawing without AECOM's express written consent. Do not scale this document. All measurements must be obtained from the stated dimensions.

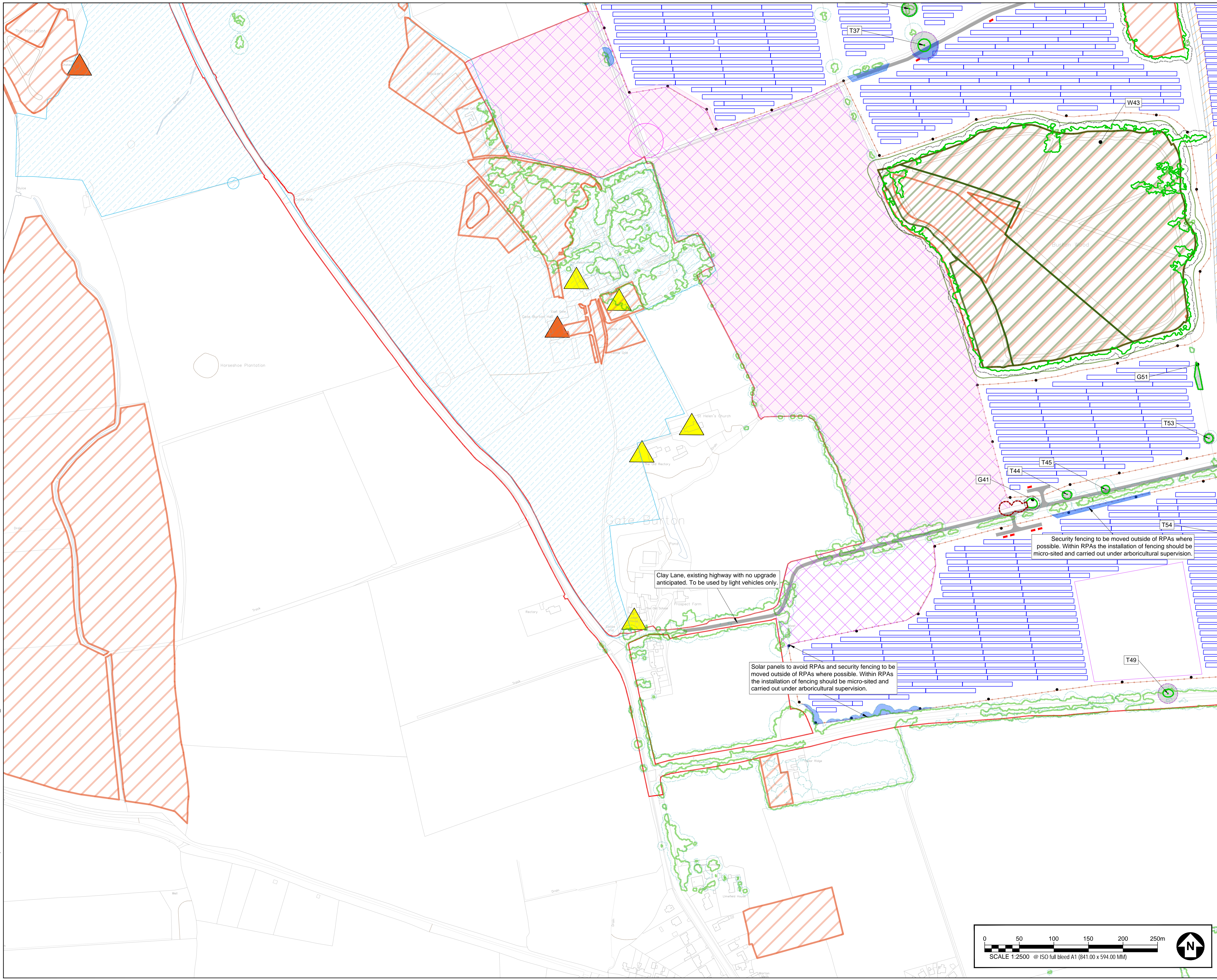

GENERAL NOTES

1. TREE CATEGORIES AS DEFINED BY BS 5837:2012
2. TREE LOCATIONS ARE BASED ON A COMBINATION OF OS MAPPING, AERIAL IMAGERY, NATIONAL TREE MAP AND GPS CO-ORDINATES FROM ON SITE WALKOVER
3. PLANS SHOULD BE READ IN CONJUNCTION WITH THE AECOM ARBORICULTURAL REPORT
4. THE ORIGINAL OF THIS DRAWING WAS PRODUCED IN COLOUR. A MONOCHROME COPY SHOULD NOT BE RELIED UPON.
5. DRAWING REFERENCES:
 Ancient Woodlands.dwg
 Priority Habitats.dwg
 OS_TR.dwg
 NTM Polygons - Copy.dwg
 TPO XREF.dwg
 LCA-2021-GateBurton_DS_00003_IllustrativeSiteLayout-DCOApplicationReference-A (Mod)

KEY PLAN

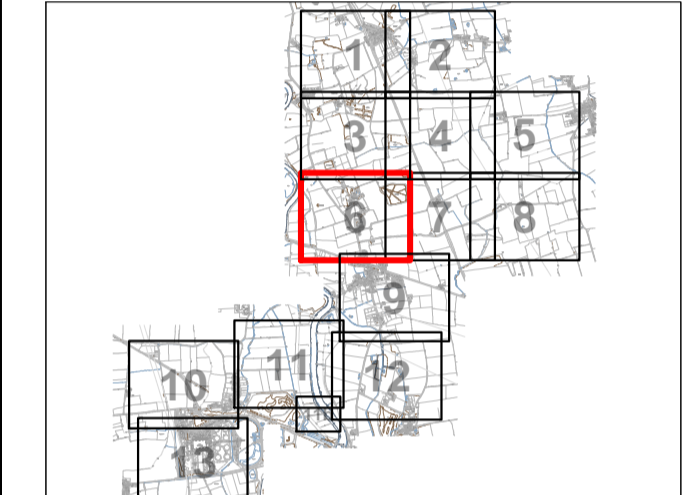

KEY

- SITE BOUNDARY
- EXISTING TREE, GROUP, WOODLAND, OR HEDGE TO BE RETAINED
- EXISTING NTM FEATURE TO BE RETAINED
- EXISTING TREE, GROUP, WOODLAND, OR HEDGE TO BE REMOVED
- EXISTING NTM FEATURE TO BE REMOVED
- ROOT PROTECTION AREA OF RETAINED TREES (AS DEFINED BY BS 5837:2012)
- ROOT PROTECTION AREA OF NTM FEATURE (AS DEFINED BY BS 5837:2012)
- VETERAN TREE ROOT PROTECTION AREAS (RPA) (AS DEFINED BY BS 5837:2012)
- TREE PROTECTION FENCING
- CONSTRUCTION EXCLUSION ZONE (CONSTRUCTION OF PLANT MATERIALS STORAGE, EXCAVATION AND ALL OTHER CONSTRUCTION ACTIVITIES ARE EXCLUDED WITHIN THESE AREAS FOR THE PURPOSES OF PROTECTING TREE HEALTH)
- CONSTRUCTION WORKING ZONE (MANAGED CONSTRUCTION PROCESSES PERMITTED IN ACCORDANCE WITH THE PRINCIPLES SET OUT WITHIN THE ARBORICULTURAL IMPACT ASSESSMENT)
- ANCIENT WOODLAND (WITH 15M BUFFER) (AREA CLASSIFIED AS AN ANCIENT WOODLAND)
- PRIORITY HABITAT (CLASSIFIED AS A PRIORITY HABITAT)

ISSUE/REVISION

NO	DATE	DESCRIPTION
P01	23.01.23	FIRST ISSUE

DRAWING STATUS

ISSUE

PROJECT NUMBER

60664324

SHEET TITLE

TREE PROTECTION AND REMOVALS PLAN (SHEET 6)

SHEET NUMBER **REV.**

60664324-ACM-XX-XX-AB-TPP-06 P01

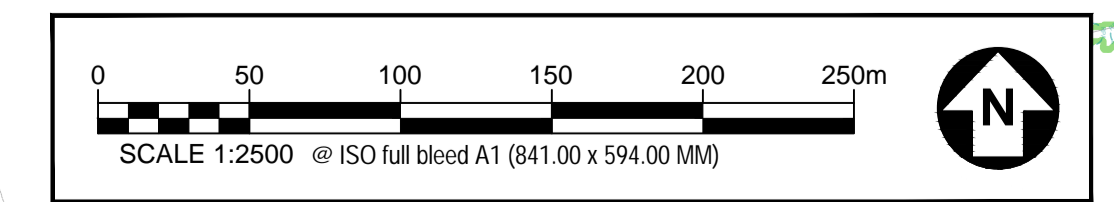

This drawing has been prepared for the use of AECOM's Client. It may not be used, modified, reproduced or relied upon by third parties, except as agreed by AECOM or as required by law. AECOM accepts no responsibility and denies any liability whatsoever to any party that uses or relies on this drawing without AECOM's express written consent. Do not scale this document. All measurements must be obtained from the stated dimensions.

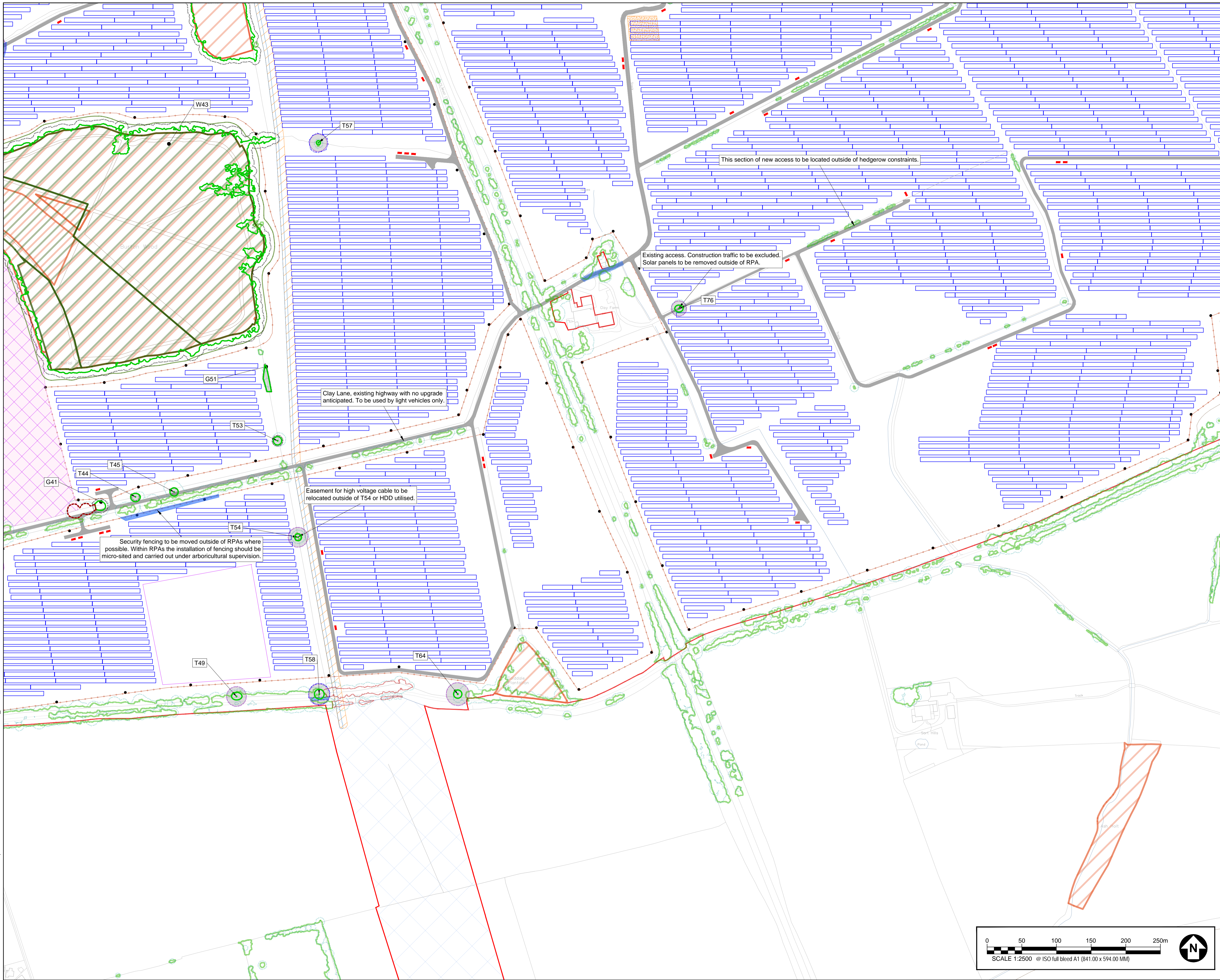

GENERAL NOTES

1. TREE CATEGORIES AS DEFINED BY BS 5837:2012
2. TREE LOCATIONS ARE BASED ON A COMBINATION OF OS MAPPING, AERIAL IMAGERY, NATIONAL TREE MAP AND GPS CO-ORDINATES FROM ON SITE WALKOVER
3. PLANS SHOULD BE READ IN CONJUNCTION WITH THE AECOM ARBORICULTURAL REPORT
4. THE ORIGINAL OF THIS DRAWING WAS PRODUCED IN COLOUR. A MONOCHROME COPY SHOULD NOT BE RELIED UPON.
5. DRAWING REFERENCES:
 Ancient Woodlands.dwg
 Priority Habitats.dwg
 OS_TR.dwg
 NTM COMBINED DATA_TR.dwg
 NTM Polygons - Copy.dwg
 TPO XREF.dwg
 LCA:2021-GateBurton_DS_00003_IllustrativeSiteLayout-DCOApplicationReference-A (Mod)

KEY PLAN

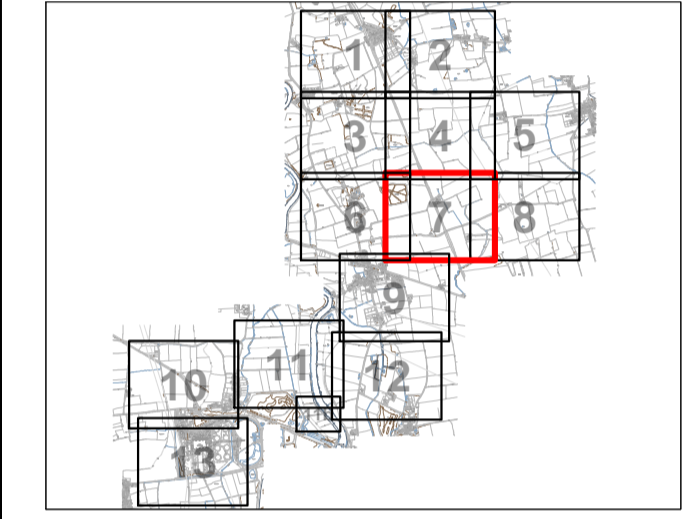

KEY

- SITE BOUNDARY
- EXISTING TREE, GROUP, WOODLAND, OR HEDGE TO BE RETAINED
- EXISTING NTM FEATURE TO BE RETAINED
- EXISTING TREE, GROUP, WOODLAND, OR HEDGE TO BE REMOVED
- EXISTING NTM FEATURE TO BE REMOVED
- ROOT PROTECTION AREA OF RETAINED TREES (AS DEFINED BY BS 5837:2012)
- ROOT PROTECTION AREA OF NTM FEATURE (AS DEFINED BY BS 5837:2012)
- VETERAN TREE ROOT PROTECTION AREAS (RPA) (AS DEFINED BY BS 5837:2012)
- TREE PROTECTION FENCING
- CONSTRUCTION EXCLUSION ZONE (STORAGE OF RAW MATERIALS, STORAGE, EXCAVATION AND ALL OTHER CONSTRUCTION ACTIVITIES ARE EXCLUDED WITHIN THESE AREAS FOR THE PURPOSES OF PROTECTING TREE HEALTH)
- CONSTRUCTION WORKING ZONE (MANAGED CONSTRUCTION PROCESSES PERMITTED IN ACCORDANCE WITH THE PRINCIPLES SET OUT WITHIN THE ARBORICULTURAL IMPACT ASSESSMENT)
- ANCIENT WOODLAND (WITH 15M BUFFER) (AREA CLASSIFIED AS AN ANCIENT WOODLAND)
- PRIORITY HABITAT (CLASSIFIED AS A PRIORITY HABITAT)

ISSUE/REVISION

NO	DATE	DESCRIPTION
P01	23.01.23	FIRST ISSUE
VR		

DRAWING STATUS

ISSUE

PROJECT NUMBER

60664324

SHEET TITLE

TREE PROTECTION AND REMOVALS PLAN (SHEET 7)

SHEET NUMBER **REV.**

60664324-ACM-XX-XX-AB-TPP-07 P01

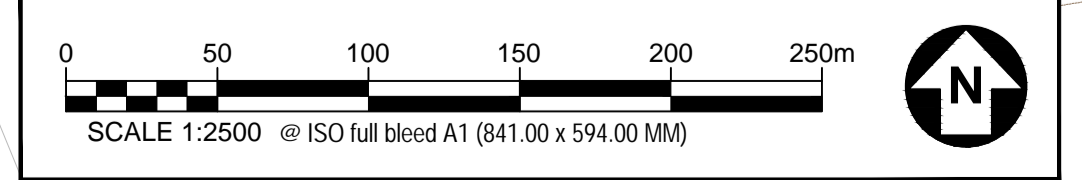

This drawing has been prepared for the use of AECOM's client. It may not be used, modified, reproduced or relied upon by third parties, except as agreed by AECOM or as required by law. AECOM accepts no responsibility and denies any liability whatsoever to any party that uses or relies on this drawing without AECOM's express written consent. Do not scale this document. All measurements must be obtained from the scaled dimensions.

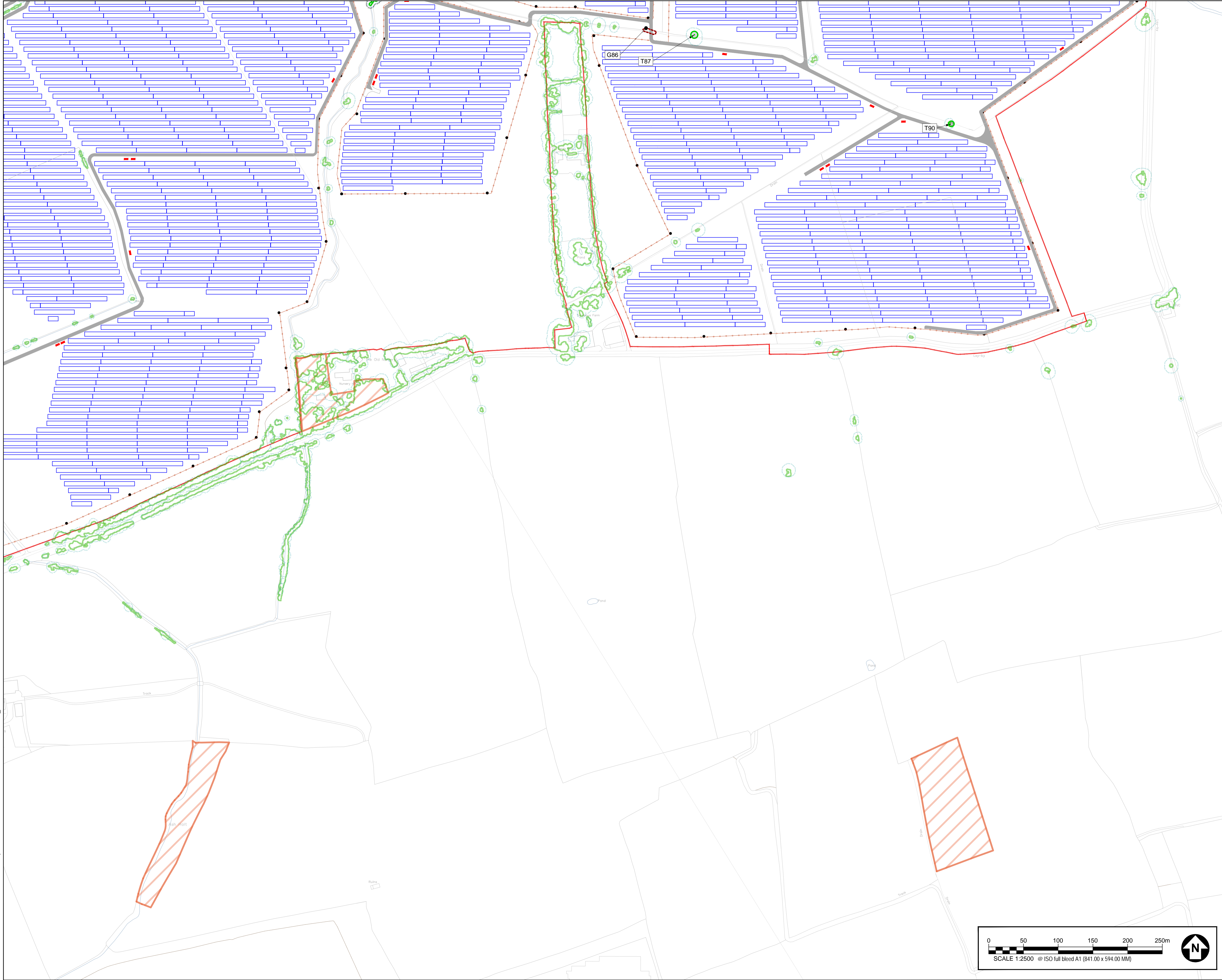

GENERAL NOTES

1. TREE CATEGORIES AS DEFINED BY BS 5837:2012
2. TREE LOCATIONS ARE BASED ON A COMBINATION OF OS MAPPING, AERIAL IMAGERY, NATIONAL TREE MAP AND GPS CO-ORDINATES FROM ON SITE WALKOVER
3. PLANS SHOULD BE READ IN CONJUNCTION WITH THE AECOM ARBORICULTURAL REPORT
4. THE ORIGINAL OF THIS DRAWING WAS PRODUCED IN COLOUR - A MONOCHROME COPY SHOULD NOT BE RELIED UPON
5. DRAWING REFERENCES:
 Ancient Woodlands.dwg
 Priority Habitats.dwg
 OS_TR.dwg
 NTM COMBINED DATA_TR.dwg
 NTM Polygons - Copy.dwg
 TPO XREF.dwg
 LCA:2021-GateBurton_DS_00003_IllustrativeSiteLayout-DCOApplicationReference-A (Modif

KEY PLAN



KEY

- SITE BOUNDARY
- EXISTING TREE, GROUP, WOODLAND, OR HEDGE TO BE RETAINED
- EXISTING NTM FEATURE TO BE RETAINED
- EXISTING TREE, GROUP, WOODLAND, OR HEDGE TO BE REMOVED
- EXISTING NTM FEATURE TO BE REMOVED
- ROOT PROTECTION AREA OF RETAINED TREES (AS DEFINED BY BS 5837:2012)
- ROOT PROTECTION AREA OF NTM FEATURE (AS DEFINED BY BS 5837:2012)
- VETERAN TREE ROOT PROTECTION AREAS (RPA) (AS DEFINED BY BS 5837:2012)
- TREE PROTECTION FENCING
- CONSTRUCTION EXCLUSION ZONE (ZONES OF HEAVY MATERIALS STORAGE, EXCAVATION AND ALL OTHER CONSTRUCTION ACTIVITIES ARE EXCLUDED WITHIN THESE AREAS FOR THE PURPOSES OF PROTECTING TREE HEALTH)
- CONSTRUCTION WORKING ZONE (MANAGED CONSTRUCTION PROCESSES PERMITTED IN ACCORDANCE WITH THE PRINCIPLES SET OUT WITHIN THE ARBORICULTURAL IMPACT ASSESSMENT)
- ANCIENT WOODLAND (WITH 15M BUFFER) (AREA CLASSIFIED AS AN ANCIENT WOODLAND)
- PRIORITY HABITAT (CLASSIFIED AS A PRIORITY HABITAT)

ISSUE/REVISION

NO	DATE	DESCRIPTION
P01	23.01.23	FIRST ISSUE
I/R	DATE	DESCRIPTION

DRAWING STATUS
ISSUE

PROJECT NUMBER
 60664324

SHEET TITLE
 TREE PROTECTION AND REMOVALS PLAN (SHEET 8)

SHEET NUMBER **REV.**
 60664324-ACM-XX-XX-AB-TPP-08 P01

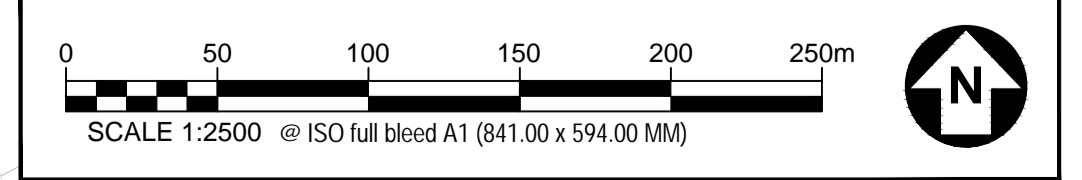

This drawing has been prepared for the use of AECOM's Client. It may not be used, modified, reproduced or relied upon by third parties, except as agreed by AECOM or as required by law. AECOM accepts no responsibility and denies any liability whatsoever to any party that uses or relies on this drawing without AECOM's express written consent. Do not scale this document. All measurements must be obtained from the stated dimensions.

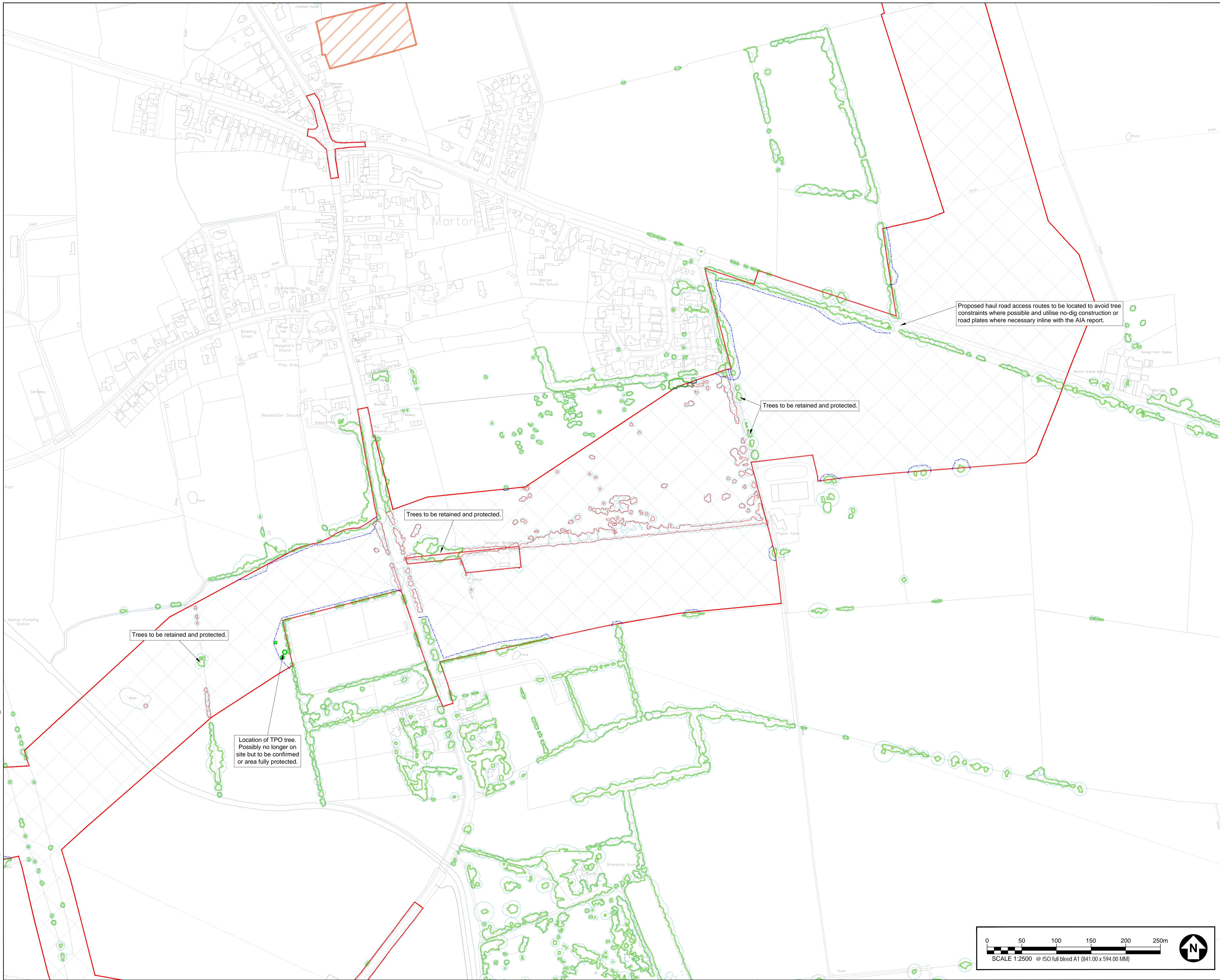

Proposed haul road access routes to be located to avoid tree constraints where possible and utilise no-dig construction or road plates where necessary inline with the AIA report.

Trees to be retained and protected.

Trees to be retained and protected.

Trees to be retained and protected.

Location of TPO tree. Possibly no longer on site but to be confirmed or area fully protected.

GENERAL NOTES

1. TREE CATEGORIES AS DEFINED BY BS 5837:2012
2. TREE LOCATIONS ARE BASED ON A COMBINATION OF OS MAPPING, AERIAL IMAGERY, NATIONAL TREE MAP AND GPS CO-ORDINATES FROM ON SITE WALKOVER
3. PLANS SHOULD BE READ IN CONJUNCTION WITH THE AECOM ARBORESCULPTURAL REPORT
4. THE ORIGINAL OF THIS DRAWING WAS PRODUCED IN COLOUR - A MONOCHROME COPY SHOULD NOT BE RELIED UPON
5. DRAWING REFERENCES:
 Ancient Woodlands.dwg
 Priority Habitats.dwg
 OS_TR.dwg
 NTM COMBINED DATA_TR.dwg
 NTM Polygons - Copy.dwg
 TPO XREF.dwg
 LCA:2021-GateBurton_DS_00003_IllustrativeSiteLayout-DCOApplicationReference-A (Mod)

KEY PLAN



KEY

- SITE BOUNDARY**
- EXISTING TREE, GROUP, WOODLAND, OR HEDGE TO BE RETAINED**
- EXISTING NTM FEATURE TO BE RETAINED**
- EXISTING TREE, GROUP, WOODLAND, OR HEDGE TO BE REMOVED**
- EXISTING NTM FEATURE TO BE REMOVED**
- ROOT PROTECTION AREA OF RETAINED TREES (AS DEFINED BY BS 5837:2012)**
- ROOT PROTECTION AREA OF NTM FEATURE (AS DEFINED BY BS 5837:2012)**
- VETERAN TREE ROOT PROTECTION AREAS (RPA) (AS DEFINED BY BS 5837:2012)**
- TREE PROTECTION FENCING**
- CONSTRUCTION EXCLUSION ZONE (EXCLUSION OF ALL MATERIALS STORAGE, EXCAVATION AND ALL OTHER CONSTRUCTION ACTIVITIES ARE EXCLUDED WITHIN THESE AREAS FOR THE PURPOSES OF PROTECTING TREE HEALTH)**
- CONSTRUCTION WORKING ZONE (MANAGED CONSTRUCTION PROCESSES PERMITTED IN ACCORDANCE WITH THE PRINCIPLES SET OUT WITHIN THE ARBORESCULPTURAL IMPACT ASSESSMENT)**
- ANCIENT WOODLAND (WITH 15M BUFFER) (AREA CLASSIFIED AS AN ANCIENT WOODLAND)**
- PRIORITY HABITAT (CLASSIFIED AS A PRIORITY HABITAT)**

ISSUE/REVISION

NO	DATE	DESCRIPTION
P01	23.01.23	FIRST ISSUE
VR		

DRAWING STATUS

ISSUE

PROJECT NUMBER

60664324

SHEET TITLE

TREE PROTECTION AND REMOVALS PLAN (SHEET 9)

SHEET NUMBER

60664324-ACM-XX-XX-AB-TPP-09

REV.

P01

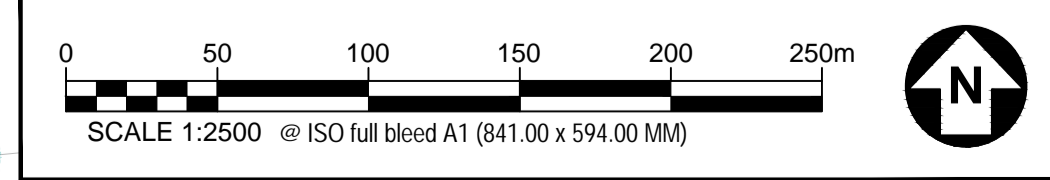

This drawing has been prepared for the use of AECOM's client. It may not be used, modified, reproduced or relied upon by third parties, except as agreed by AECOM or as required by law. AECOM accepts no responsibility and denies any liability whatsoever to any party that uses or relies on this drawing without AECOM's express written consent. Do not scale this document. All measurements must be obtained from the stated dimensions.

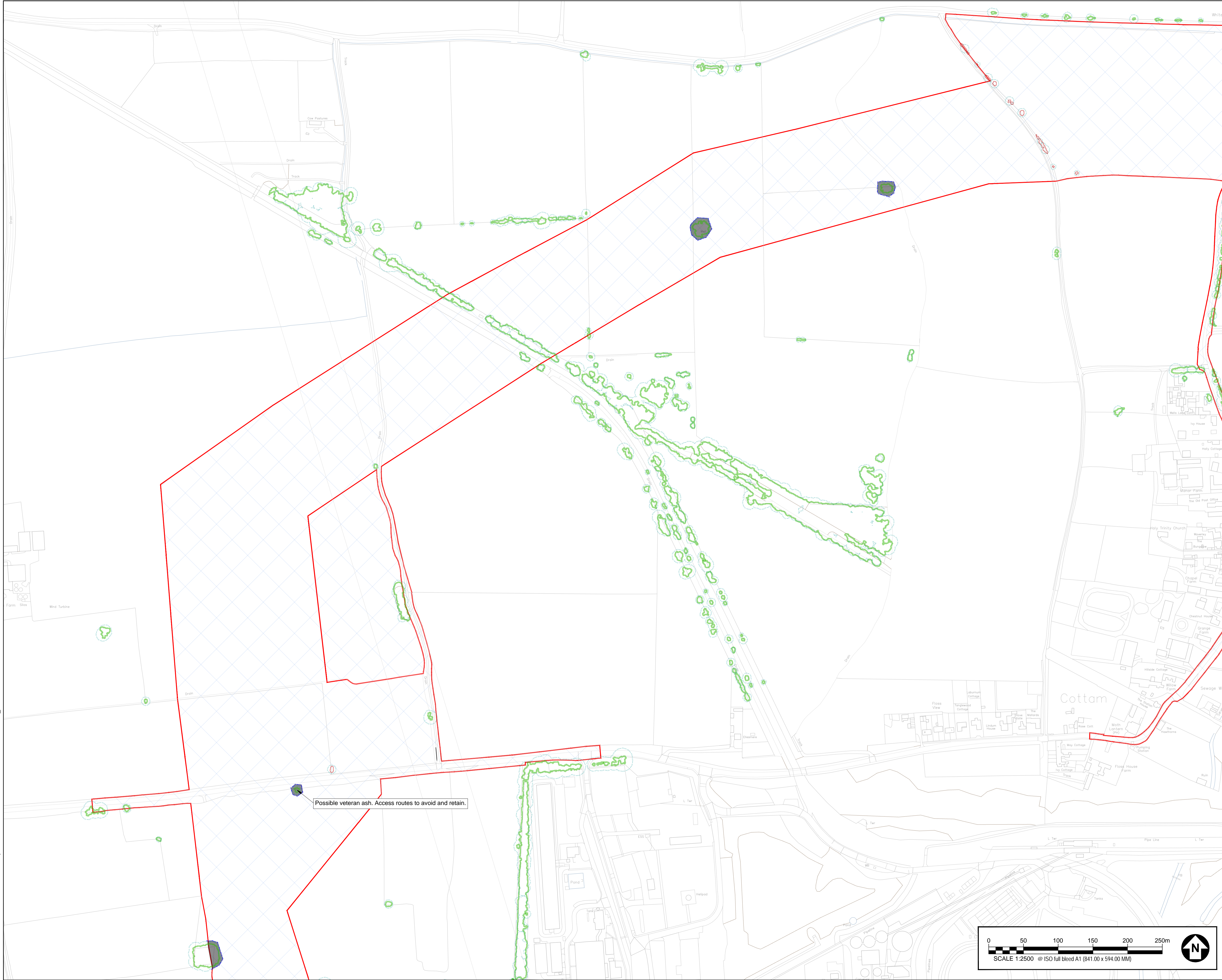

Possible veteran ash. Access routes to avoid and retain.



PROJECT
GATE BURTON ENERGY PARK
CLIENT

GATE BURTON ENERGY PARK LTD
CONSULTANT

AECOM
 Plumer House, Third Floor,
 East Wing, Tallyour Road
 Plymouth, PL6 5DH
 Tel +44(0)1752 676700
 Fax +44(0)870 238 6023
 www.aecom.com

- GENERAL NOTES**
- TREE CATEGORIES AS DEFINED BY BS 5837:2012
 - TREE LOCATIONS ARE BASED ON A COMBINATION OF OS MAPPING, AERIAL IMAGERY, NATIONAL TREE MAP AND GPS CO-ORDINATES FROM ON SITE WALKOVER
 - PLANS SHOULD BE READ IN CONJUNCTION WITH THE AECOM ARBORICULTURAL REPORT
 - THE ORIGINAL OF THIS DRAWING WAS PRODUCED IN COLOUR. A MONOCHROME COPY SHOULD NOT BE RELIED UPON.
 - DRAWING REFERENCES:
 Ancient Woodlands.dwg
 Priority Habitats.dwg
 OS_TR.dwg
 NTM COMBINED DATA_TR.dwg
 NTM Polygons - Copy.dwg
 TPO XREF.dwg
 LCA-2021-GateBurton_DS_00003_IllustrativeSiteLayout-DCOApplicationReference-A (Mod)

KEY PLAN

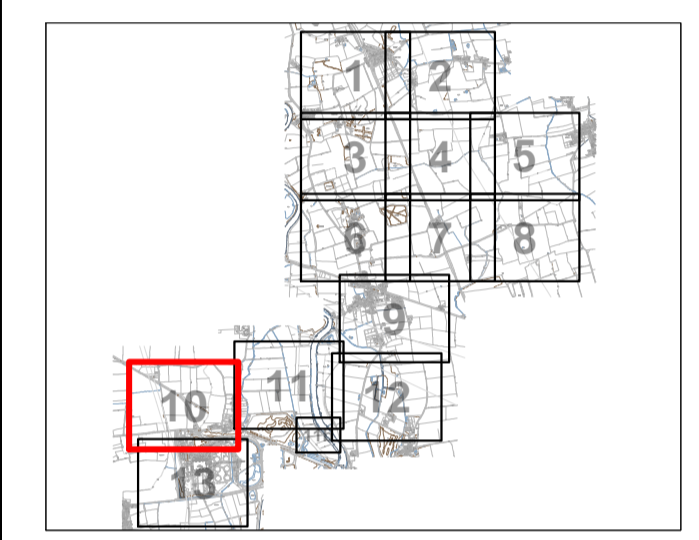

- KEY**
- SITE BOUNDARY**
 - EXISTING TREE, GROUP, WOODLAND, OR HEDGE TO BE RETAINED**
 - EXISTING NTM FEATURE TO BE RETAINED**
 - EXISTING TREE, GROUP, WOODLAND, OR HEDGE TO BE REMOVED**
 - EXISTING NTM FEATURE TO BE REMOVED**
 - ROOT PROTECTION AREA OF RETAINED TREES (AS DEFINED BY BS 5837:2012)**
 - ROOT PROTECTION AREA OF NTM FEATURE (AS DEFINED BY BS 5837:2012)**
 - VETERAN TREE ROOT PROTECTION AREAS (RPA) (AS DEFINED BY BS 5837:2012)**
 - TREE PROTECTION FENCING**
 - CONSTRUCTION EXCLUSION ZONE (STORAGE OF RAW MATERIALS, STORAGE, EXCAVATION AND ALL OTHER CONSTRUCTION ACTIVITIES ARE EXCLUDED WITHIN THESE AREAS FOR THE PURPOSES OF PROTECTING TREES AND NTM)**
 - CONSTRUCTION WORKING ZONE (MANAGED CONSTRUCTION PROCESSES PERMITTED IN ACCORDANCE WITH THE PRINCIPLES SET OUT WITHIN THE ARBORICULTURAL IMPACT ASSESSMENT)**
 - ANCIENT WOODLAND (WITH 15M BUFFER) (AREA CLASSIFIED AS AN ANCIENT WOODLAND)**
 - PRIORITY HABITAT (CLASSIFIED AS A PRIORITY HABITAT)**

ISSUE/REVISION

NO	DATE	DESCRIPTION
P01	23.01.23	FIRST ISSUE
I/R		

DRAWING STATUS
ISSUE

PROJECT NUMBER
 60664324

SHEET TITLE
TREE PROTECTION AND REMOVALS PLAN (SHEET 10)

SHEET NUMBER **REV.**
 60664324-ACM-XX-XX-AB-TPP-010 P01

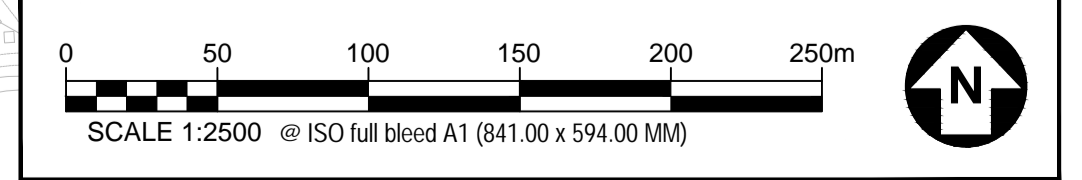

This drawing has been prepared for the use of AECOM's client. It may not be used, modified, reproduced or relied upon by third parties, except as agreed by AECOM or as required by law. AECOM accepts no responsibility and denies any liability whatsoever to any party that uses or relies on this drawing without AECOM's express written consent. Do not scale this document. All measurements must be obtained from the stated dimensions.

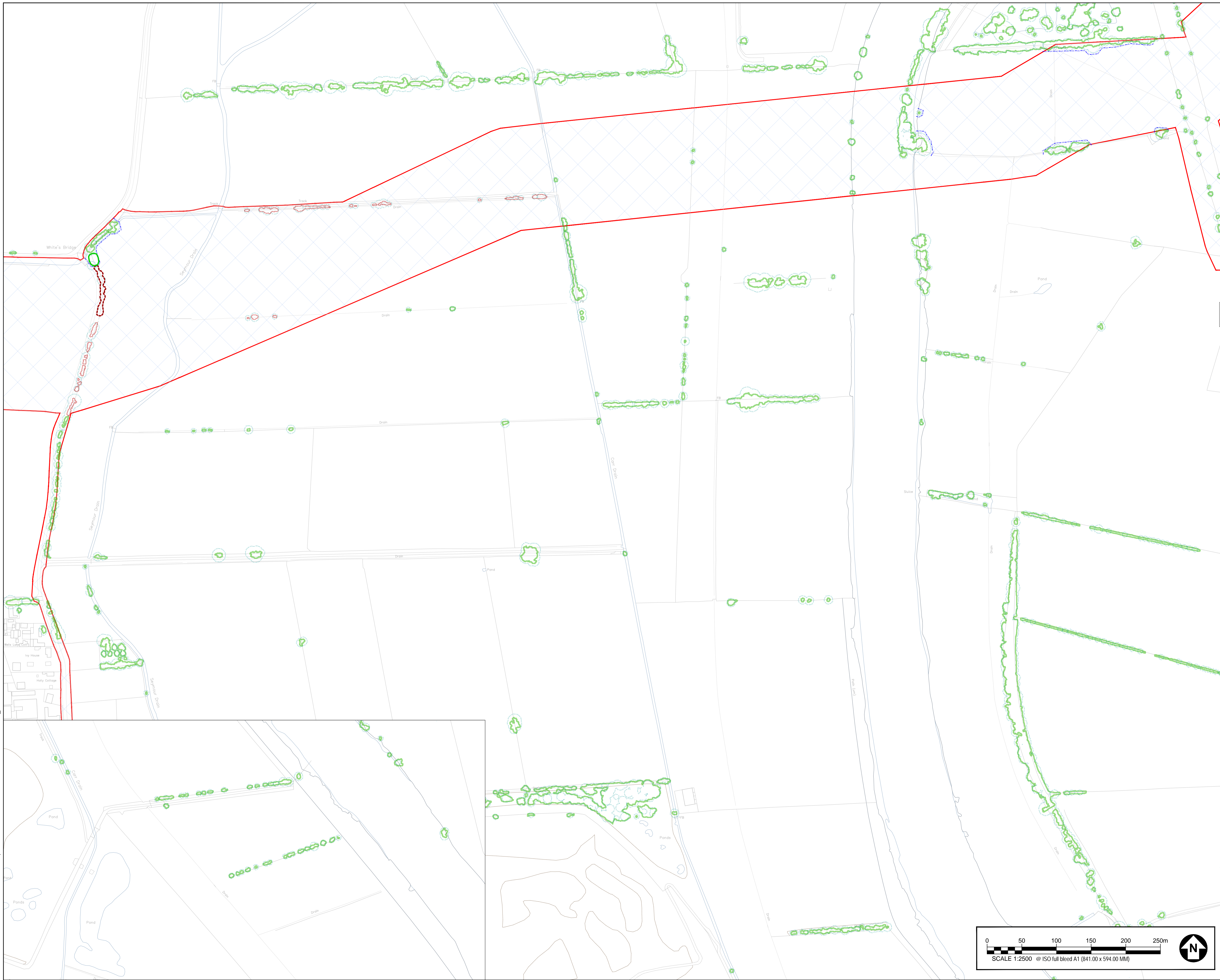

PROJECT
GATE BURTON ENERGY PARK
CLIENT

GATE BURTON ENERGY PARK LTD
CONSULTANT

AECOM
 Plumer House, Third Floor,
 East Wing, Tallyour Road
 Plymouth, PL6 5DH
 Tel +44(0)1752 676700
 Fax +44(0)870 238 6023
 www.aecom.com

GENERAL NOTES

- TREE CATEGORIES AS DEFINED BY BS 5837:2012
- TREE LOCATIONS ARE BASED ON A COMBINATION OF OS MAPPING, AERIAL IMAGERY, NATIONAL TREE MAP AND GPS CO-ORDINATES FROM ON SITE WALKOVER
- PLANS SHOULD BE READ IN CONJUNCTION WITH THE AECOM ARBORICULTURAL REPORT
- THE ORIGINAL OF THIS DRAWING WAS PRODUCED IN COLOUR - A MONOCHROME COPY SHOULD NOT BE RELIED UPON
- DRAWING REFERENCES:
 Ancient Woodlands.dwg
 Priority Habitats.dwg
 OS_TR.dwg
 NTM COMBINED DATA_TR.dwg
 NTM Polygons - Copy.dwg
 TPO XREF.dwg
 LCA-2021-GateBurton_DS_00003_IllustrativeSiteLayout-DCOApplicationReference-A (Mod)

KEY PLAN

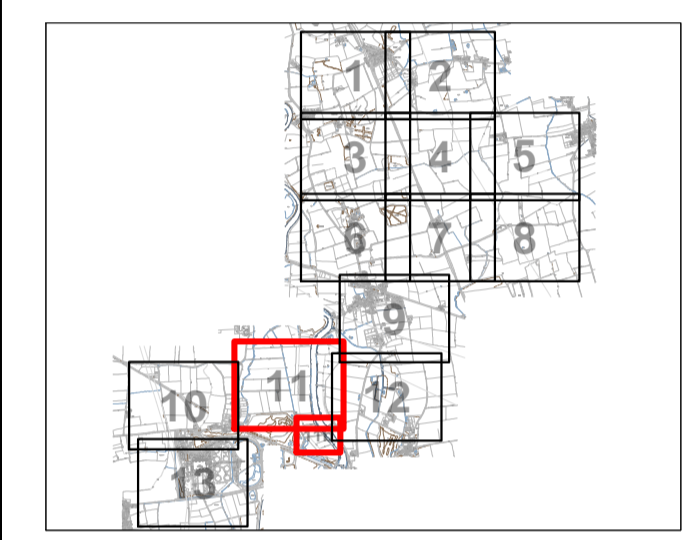

KEY

- SITE BOUNDARY
- EXISTING TREE, GROUP, WOODLAND, OR HEDGE TO BE RETAINED
- EXISTING NTM FEATURE TO BE RETAINED
- EXISTING TREE, GROUP, WOODLAND, OR HEDGE TO BE REMOVED
- EXISTING NTM FEATURE TO BE REMOVED
- ROOT PROTECTION AREA OF RETAINED TREES (AS DEFINED BY BS 5837:2012)
- ROOT PROTECTION AREA OF NTM FEATURE (AS DEFINED BY BS 5837:2012)
- VETERAN TREE ROOT PROTECTION AREAS (RPA) (AS DEFINED BY BS 5837:2012)
- TREE PROTECTION FENCING
- CONSTRUCTION EXCLUSION ZONE (CONSTRUCTION OF PLANT MATERIALS STORAGE, EXCAVATION AND ALL OTHER CONSTRUCTION ACTIVITIES ARE EXCLUDED WITHIN THESE AREAS FOR THE PURPOSES OF PROTECTING TREE HEALTH)
- CONSTRUCTION WORKING ZONE (MANAGED CONSTRUCTION PROCESSES PERMITTED IN ACCORDANCE WITH THE PRINCIPLES SET OUT WITHIN THE ARBORICULTURAL IMPACT ASSESSMENT)
- ANCIENT WOODLAND (WITH 15M BUFFER) (AREA CLASSIFIED AS AN ANCIENT WOODLAND)
- PRIORITY HABITAT (CLASSIFIED AS A PRIORITY HABITAT)

ISSUE/REVISION

NO	DATE	DESCRIPTION
P01	23.01.23	FIRST ISSUE
VR		

DRAWING STATUS

ISSUE

PROJECT NUMBER

60664324

SHEET TITLE

TREE PROTECTION AND REMOVALS PLAN (SHEET 11)

SHEET NUMBER

60664324-ACM-XX-XX-AB-TPP-011

REV.

P01

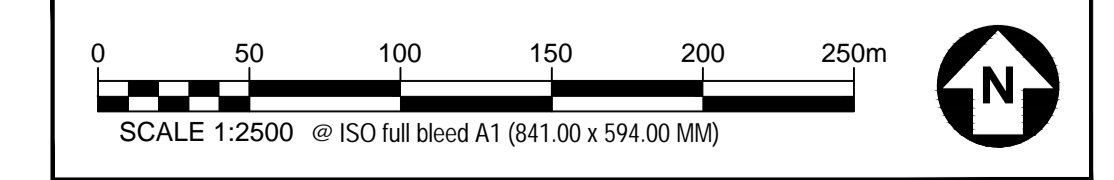

This drawing has been prepared for the use of AECOM's Client. It may not be used, modified, reproduced or relied upon by third parties, except as agreed by AECOM or as required by law. AECOM accepts no responsibility and denies any liability whatsoever to any party that uses or relies on this drawing without AECOM's express written consent. Do not scale this document. All measurements must be obtained from the stated dimensions.

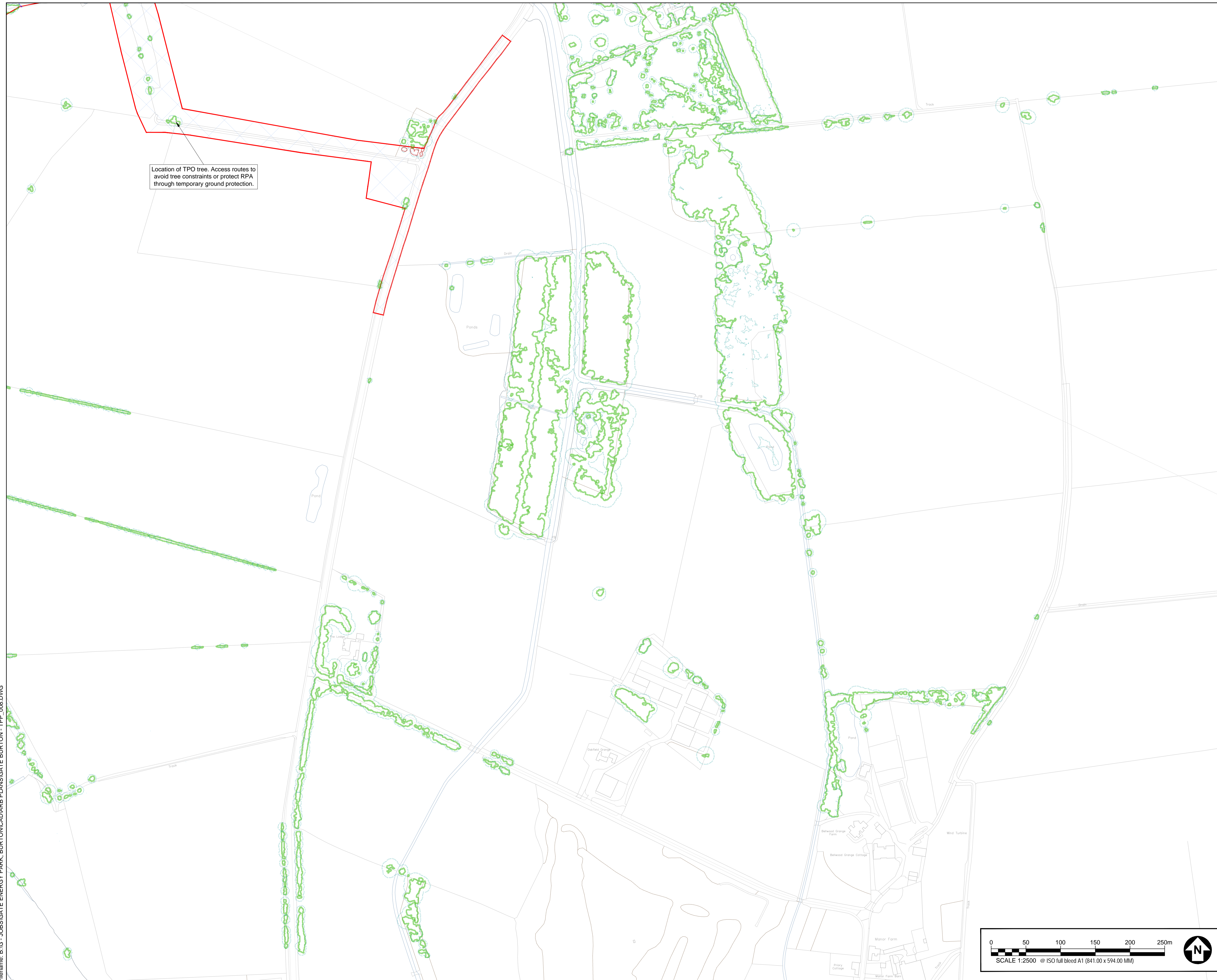

GENERAL NOTES

1. TREE CATEGORIES AS DEFINED BY BS 5837:2012
2. TREE LOCATIONS ARE BASED ON A COMBINATION OF OS MAPPING, AERIAL IMAGERY, NATIONAL TREE MAP AND GPS CO-ORDINATES FROM ON SITE WALKOVER
3. PLANS SHOULD BE READ IN CONJUNCTION WITH THE AECOM ARBORICULTURAL REPORT
4. THE ORIGINAL OF THIS DRAWING WAS PRODUCED IN COLOUR - A MONOCHROME COPY SHOULD NOT BE RELIED UPON
5. DRAWING REFERENCES:
 Ancient Woodlands.dwg
 Priority Habitats.dwg
 OS_TR.dwg
 NTM COMBINED DATA_TR.dwg
 NTM Polygons - Copy.dwg
 TPO XREF.dwg
 LCA:2021-GateBurton_DS_00003_IllustrativeSiteLayout-DCOApplicationReference-A (Mod)

KEY PLAN

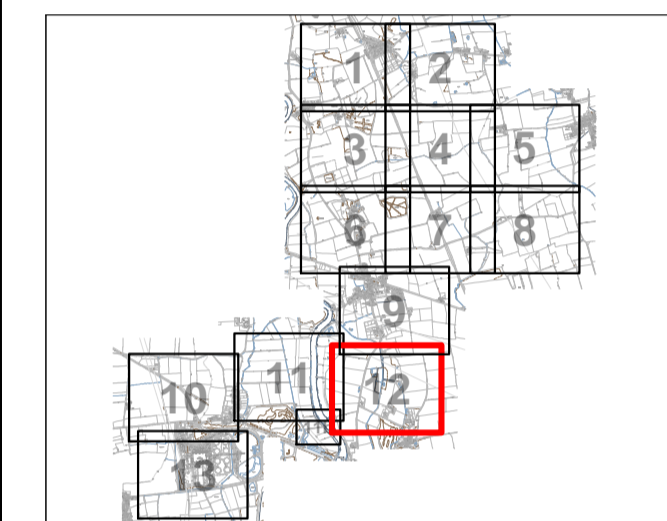

KEY

- SITE BOUNDARY
- EXISTING TREE, GROUP, WOODLAND, OR HEDGE TO BE RETAINED
- EXISTING NTM FEATURE TO BE RETAINED
- EXISTING TREE, GROUP, WOODLAND, OR HEDGE TO BE REMOVED
- EXISTING NTM FEATURE TO BE REMOVED
- ROOT PROTECTION AREA OF RETAINED TREES (AS DEFINED BY BS 5837:2012)
- ROOT PROTECTION AREA OF NTM FEATURE (AS DEFINED BY BS 5837:2012)
- VETERAN TREE ROOT PROTECTION AREAS (RPA) (AS DEFINED BY BS 5837:2012)
- TREE PROTECTION FENCING
- CONSTRUCTION EXCLUSION ZONE (CONSTRUCTION OF RAW MATERIALS STORAGE, EXCAVATION AND ALL OTHER CONSTRUCTION ACTIVITIES ARE EXCLUDED WITHIN THESE AREAS FOR THE PURPOSES OF PROTECTING TREE HEALTH)
- CONSTRUCTION WORKING ZONE (MANAGED CONSTRUCTION PROCESSES PERMITTED IN ACCORDANCE WITH THE PRINCIPLES SET OUT WITHIN THE ARBORICULTURAL IMPACT ASSESSMENT)
- ANCIENT WOODLAND (WITH 15M BUFFER) (AREA CLASSIFIED AS AN ANCIENT WOODLAND)
- PRIORITY HABITAT (CLASSIFIED AS A PRIORITY HABITAT)

ISSUE/REVISION

NO	DATE	DESCRIPTION
P01	23.01.23	FIRST ISSUE
VR		

DRAWING STATUS

ISSUE

PROJECT NUMBER

60664324

SHEET TITLE

TREE PROTECTION AND REMOVALS PLAN (SHEET 12)

SHEET NUMBER

60664324-ACM-XX-XX-AB-TPP-012

REV.

P01

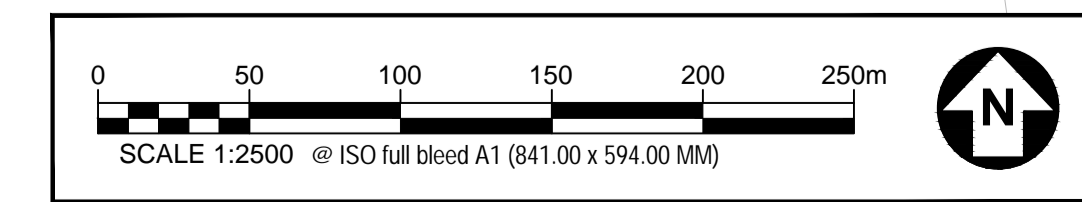

This drawing has been prepared for the use of AECOM's Client. It may not be used, modified, reproduced or relied upon by third parties, except as agreed by AECOM or as required by law. AECOM accepts no responsibility and denies any liability whatsoever to any party that uses or relies on this drawing without AECOM's express written consent. Do not scale this document. All measurements must be obtained from the stated dimensions.

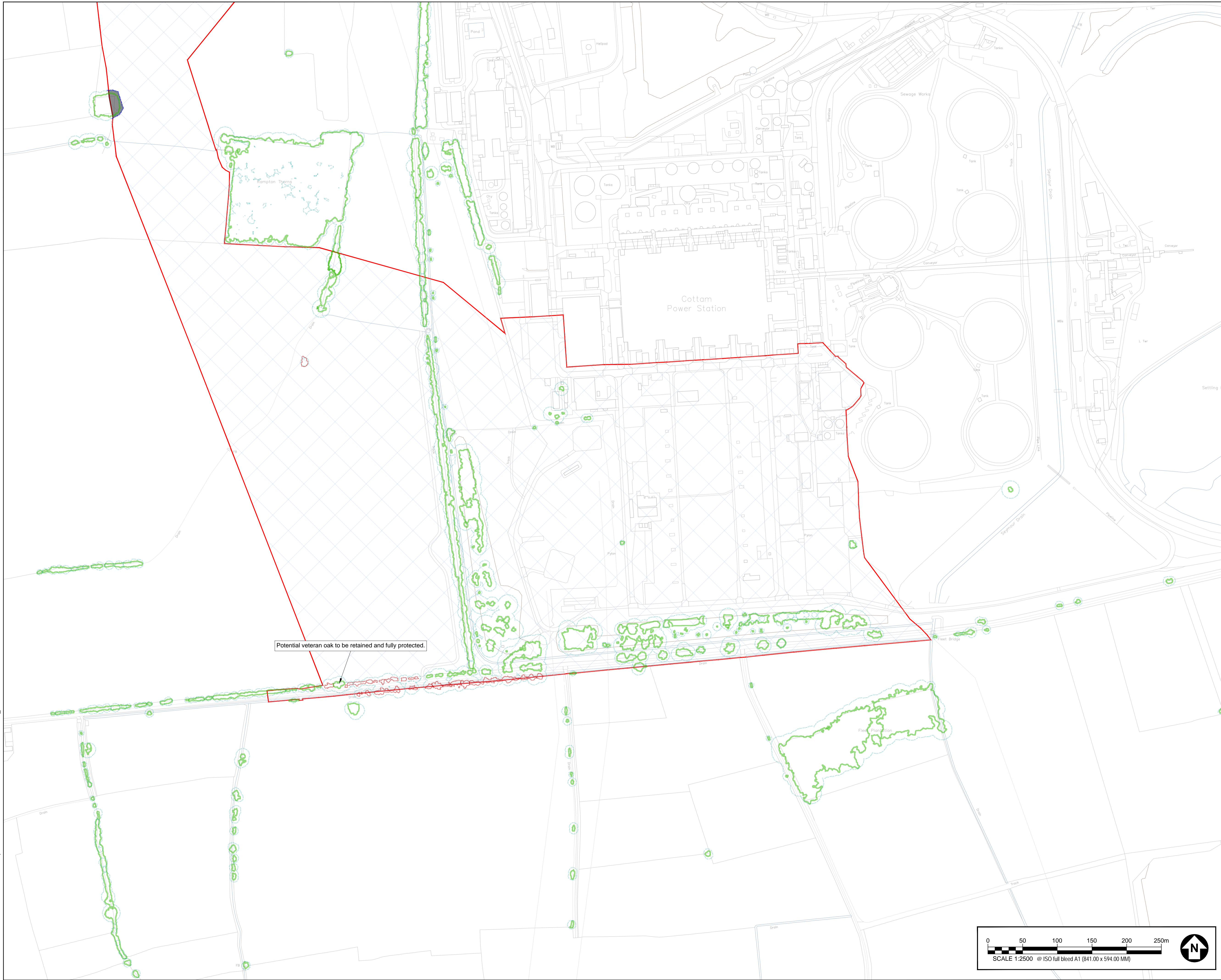

GENERAL NOTES

1. TREE CATEGORIES AS DEFINED BY BS 5837:2012
2. TREE LOCATIONS ARE BASED ON A COMBINATION OF OS MAPPING, AERIAL IMAGERY, NATIONAL TREE MAP AND GPS CO-ORDINATES FROM ON SITE WALKOVER
3. PLANS SHOULD BE READ IN CONJUNCTION WITH THE AECOM ARBORICULTURAL REPORT
4. THE ORIGINAL OF THIS DRAWING WAS PRODUCED IN COLOUR - A MONOCHROME COPY SHOULD NOT BE RELIED UPON
5. DRAWING REFERENCES:
 Ancient Woodlands.dwg
 Priority Habitats.dwg
 OS_TR.dwg
 NTM COMBINED DATA_TR.dwg
 NTM Polygons - Copy.dwg
 TPO XREF.dwg
 LCA-2021-GateBurton_DS_00003_IllustrativeSiteLayout-DCOApplicationReference-A (Mod)

KEY PLAN

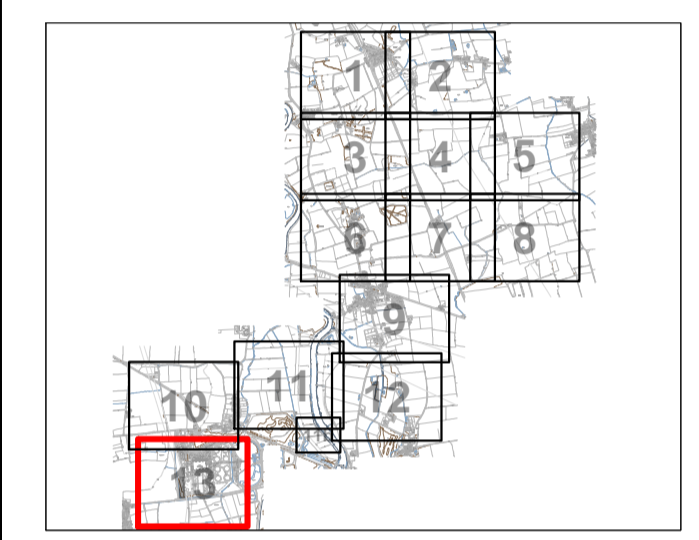

KEY

- SITE BOUNDARY**
- EXISTING TREE, GROUP, WOODLAND, OR HEDGE TO BE RETAINED**
- EXISTING NTM FEATURE TO BE RETAINED**
- EXISTING TREE, GROUP, WOODLAND, OR HEDGE TO BE REMOVED**
- EXISTING NTM FEATURE TO BE REMOVED**
- ROOT PROTECTION AREA OF RETAINED TREES (AS DEFINED BY BS 5837:2012)**
- ROOT PROTECTION AREA OF NTM FEATURE (AS DEFINED BY BS 5837:2012)**
- VETERAN TREE ROOT PROTECTION AREAS (RPA) (AS DEFINED BY BS 5837:2012)**
- TREE PROTECTION FENCING**
- CONSTRUCTION EXCLUSION ZONE (EXCLUSION OF SOILS, MATERIALS STORAGE, EXCAVATION AND ALL OTHER CONSTRUCTION ACTIVITIES ARE EXCLUDED WITHIN THESE AREAS FOR THE PURPOSES OF PROTECTING TREE HEALTH)**
- CONSTRUCTION WORKING ZONE (MANAGED CONSTRUCTION PROCESSES PERMITTED IN ACCORDANCE WITH THE PRINCIPLES SET OUT WITHIN THE ARBORICULTURAL IMPACT ASSESSMENT)**
- ANCIENT WOODLAND (WITH 15M BUFFER) (AREA CLASSIFIED AS AN ANCIENT WOODLAND)**
- PRIORITY HABITAT (CLASSIFIED AS A PRIORITY HABITAT)**

ISSUE/REVISION

NO	DATE	DESCRIPTION
P01	23.01.23	FIRST ISSUE
VR		

DRAWING STATUS
ISSUE

PROJECT NUMBER
 60664324

SHEET TITLE
TREE PROTECTION AND REMOVALS PLAN (SHEET 13)

SHEET NUMBER **REV.**
 60664324-ACM-XX-XX-AB-TPP-013 P01

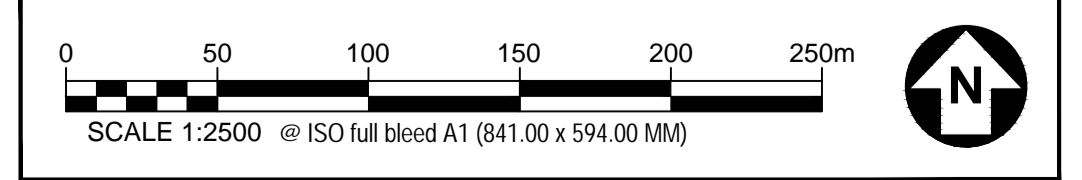

This drawing has been prepared for the use of AECOM's Client. It may not be used, modified, reproduced or relied upon by third parties, except as agreed by AECOM or as required by law. AECOM accepts no responsibility and denies any liability whatsoever, to any party that uses or relies on this drawing without AECOM's express written consent. Do not scale this document. All measurements must be obtained from the stated dimensions.

Annex E. Outline Tree Protection Measures

a. Outline Tree Protection Measures

The default position as set out by BS 5837:2012 is that retained trees must be protected from construction operations with the erection of robust protective fencing positioned on the outer edge of the RPA or crown spread (whichever is greatest). All site operations will be restricted to the area outside of tree protection fencing and this area will form a Construction Exclusion Zone (CEZ) unless agreed otherwise. Protection measures will be installed as set out in the Tree Protection Plan included as Appendix E of this report.

The area inside the fence and any additional tree protection measures will be sacrosanct and must not be removed or altered without the prior approval of the LPA Tree Officer. Any damage to tree protection measures must be reported immediately.

Fencing shall be constructed with robust vertical and horizontal scaffold framework with weldmesh panels firmly attached as per BS 5837:2012 Figure 7 (included below). Vertical support poles and bracing poles must be located with care to avoid underground utility services and will be sited to avoid the structural roots of retained trees.

Alternative equivalent robust and immovable fencing specification including site hoarding will also be appropriate.

Suitable all-weather signage will be fixed to fencing to notify site staff and visitors of the construction exclusion zone and its purpose (example included as Appendix G).

When entering and exiting the site the fencing contractor must avoid the production of ruts on the unprotected surface of the ground.

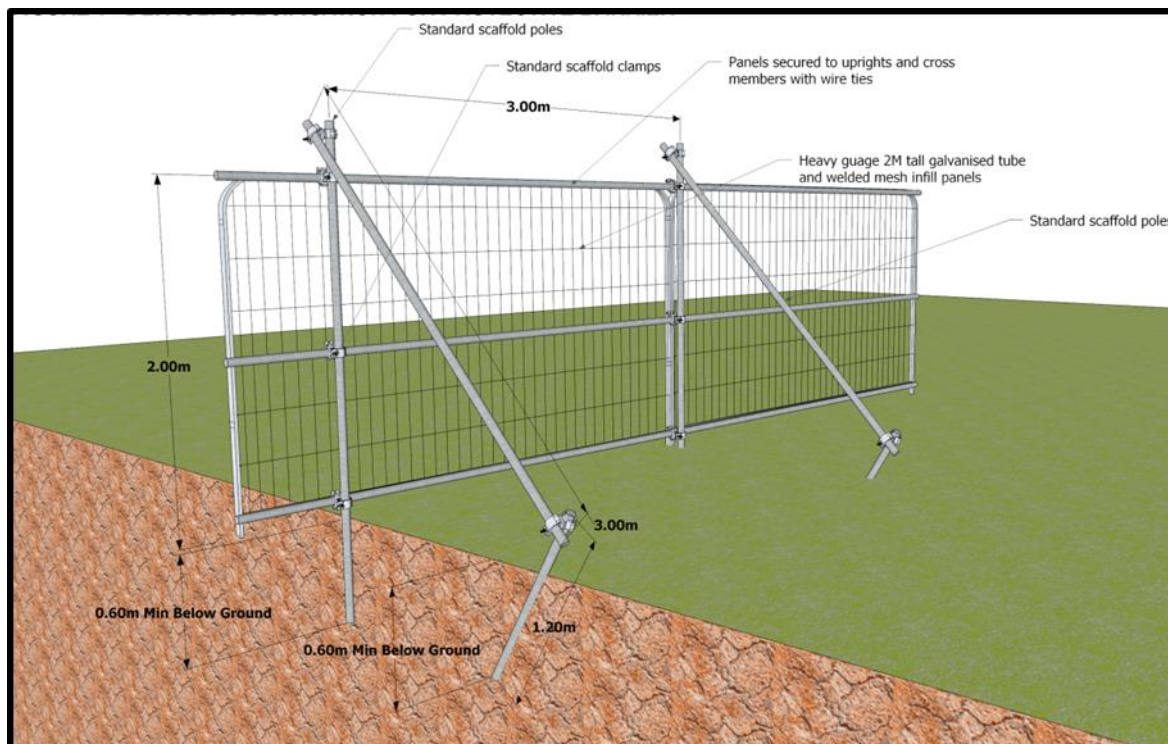

Figure 4 Default specification for protective barrier

b. Ground Protection

Should access be unavoidable within the RPA of a retained tree, fit for purpose ground protection must be in place which is sufficient to protect the structure of the soil from damage based on the heaviest anticipated load.

As set out in section 6.2.3.3 of BS5837:2012 the following ground protection measures will be appropriate:

- Suitable ground protection for pedestrian only access will comprise a single thickness of scaffold boards set on a compressible layer of 100mm of woodchip on a geotextile separation layer.
- Pedestrian operated plant up to two tonnes in weight would require the use of a proprietary ground protection system (such as Ground Guards or Eve Trakway or equivalent) set on a minimum depth of 150mm woodchip or sharp sand.
- Heavier loads will require ground protection to an engineering specification in conjunction with arboricultural advice.

As a guide the threshold beyond which root development is significantly affected is a bulk density ranging from 1.4g per cm³ for clay soils, to 1.75g per cm³ for sandy soils.

Tree protective measures shall stay in place until all construction operations are completed and removal is agreed with the Site arboriculturist and/or the Local Authority Tree Officer as appropriate.

c. General guidance for the management of exposed roots

Excavation must only take place within the RPA of a retained tree with the prior agreement of an arboriculturist and the Local Authority Tree Officer. All excavation must be undertaken using hand tools or compressed air (such as an air spade).

The following general principles will apply:

- Individual or small groups of roots less than 25mm in diameter will be retained where possible but can be severed with a sharp tool such as secateurs or pruning saws to leave a clean cut end (ideally 100mm back from the face of the excavation to account for future regrowth) where they pose an obstruction.
- Where roots are encountered which are larger than 25mm in diameter or where significant groups of smaller roots are found, the advice of an arboriculturist must be sought to decide an appropriate course of action (following consultation with the Local Authority Tree Officer where appropriate).
- Roots must only be exposed for the minimum period possible. In the interim period any exposed roots must be completely covered with dampened hessian sacking (which may require ongoing re wetting) to avoid drying out and exposure to light (which can result in the death of roots). Backfill for excavations should utilise the parent material and must not be significantly compacted.

d. Storage, use and mixing of materials

The use, mixing and washing of materials can lead to run off or inadvertent spillage into tree root zones. Many substances often used on construction sites can be toxic to tree roots (such as concrete, fuels, salts, builders sand and herbicides), can result in the death of tree roots and beneficial soil organisms; and have a significant impact on the future health and appearance of trees.

The storage of materials can result in an effective raised soil level. This buries tree roots at depths where air and water are less available and can lead to the decline or death of the tree.

For these reasons the storage of materials and any washing, mixing or refuelling must take place in agreed allocated areas at least 10m from the edge of the RPA of retained trees.

Any slope effect must be taken into account and where there is a potential for run off, heavy duty polythene sheeting and sandbags must be in place as bunding to prevent toxic materials reaching RPAs.

Annex F. Tree Protection Signage (Example)

